

Machined Mold Clamps

FEATURES:

Our complete line of mold clamps are available in an extensive range of sizes. Clamps are available in open-toe and closed-toe styles, as well as heavy duty and extra heavy duty versions.

- Quick and Easy Adjustment Reduces Setup Time
- Clamps Made from Premium Quality Steel, Hardened for Extended Life, and Coated with Black Penetrate Finish to Prevent Rust
- Unique Swivel-based Adjusting Screw Provides Maximum Flexibility and Accuracy

Available as individual components or complete clamp assemblies.

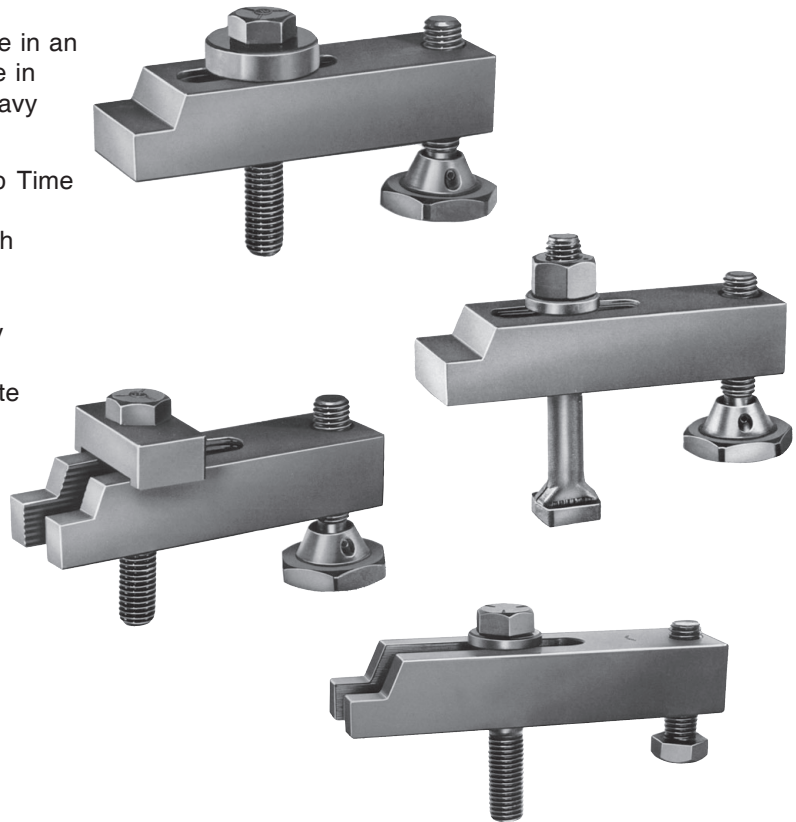

***BUY A COMPLETE
MOLD CLAMP ASSEMBLY
OR INDIVIDUAL PARTS***

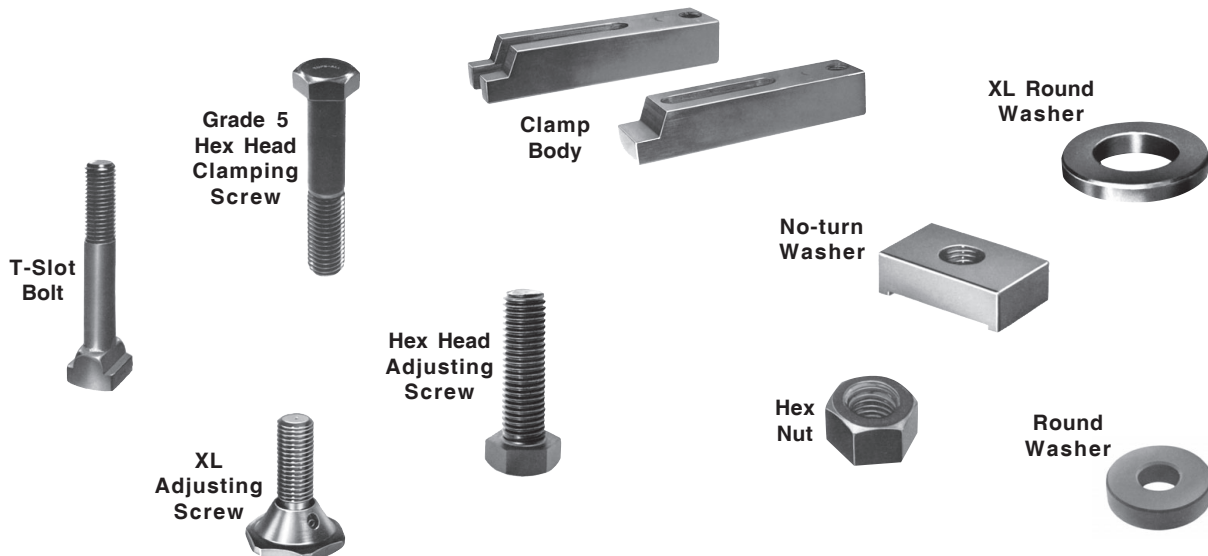

Machined Mold Clamps...continued

Open Toe Style: Heavy Duty (with Swivel-Base Adjusting Screw)

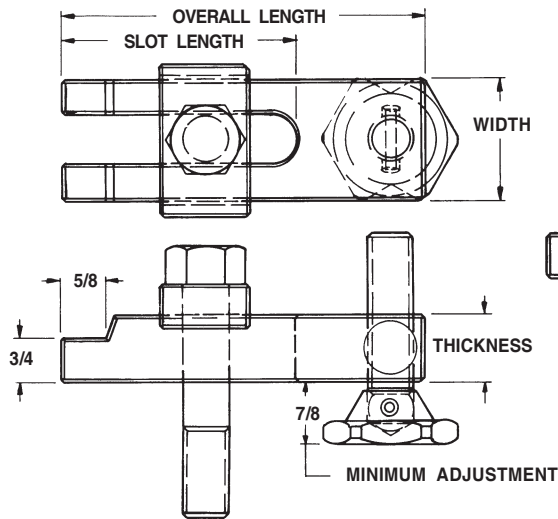
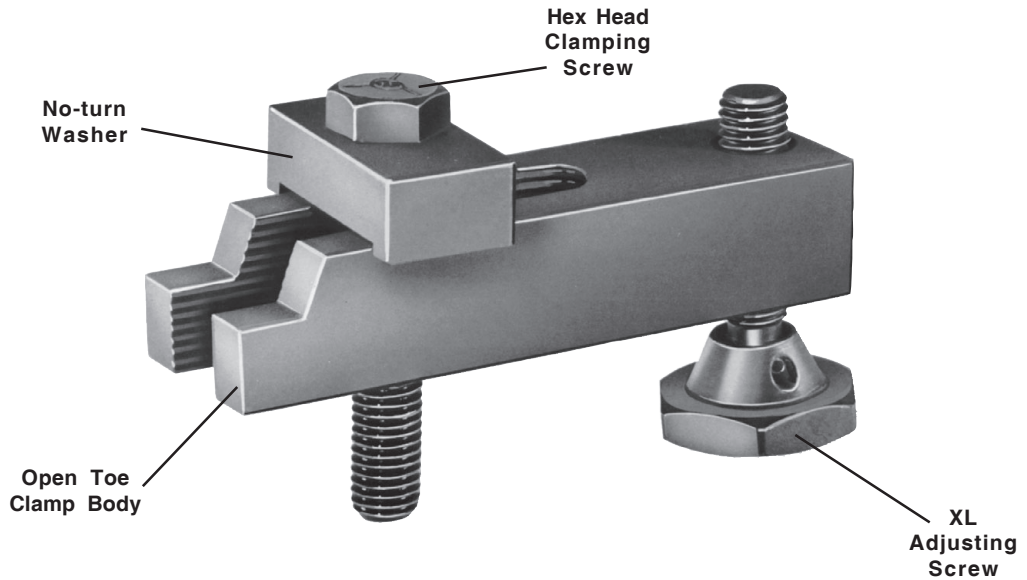

Also Available with Non-Swivel Base

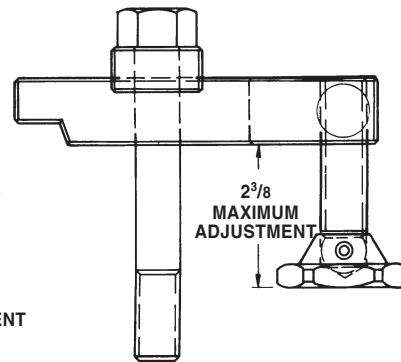

For Clamping Screw Diameter	Clamping Screw Size Supplied With Assembly (Diameter x Length)	Mold Clamp Body Specifications				Complete Assembly Part Number	Price Each	Individual Clamp Bodies Part Number	Price Each
		Thickness	Width	Slot Length	Overall Length				
5/8"	5/8"-11 x 3 1/2"	1"	1 3/4"	2 3/4"	4"	TAC-584-A	\$32.05	HD-584	\$17.40
				3 1/4"	5"	TAC-585-A	\$34.00	HD-585	\$19.35
				3 3/4"	6"	TAC-586-A	\$36.20	HD-586	\$21.55
				4 1/4"	7"	TAC-587-A	\$37.85	HD-587	\$23.80
3/4"	3/4"-10 x 4"	1 1/8"	2"	3 3/8"	5"	TAC-755-A	\$41.15	HD-755	\$24.05
				3 7/8"	6"	TAC-756-A	\$43.40	HD-756	\$26.25
				4 3/8"	7"	TAC-757-A	\$45.60	HD-757	\$28.45
				5 3/8"	8"	TAC-758-A	\$48.10	HD-758	\$30.95
1"	1"-8 x 5"	1 1/2"	2 1/2"	6"	10"	TAC-110-A	\$72.95	HD-110	\$42.30

Machined Mold Clamps...continued

Open Toe Style: Extra Heavy Duty (with Swivel-Base Adjusting Screw)

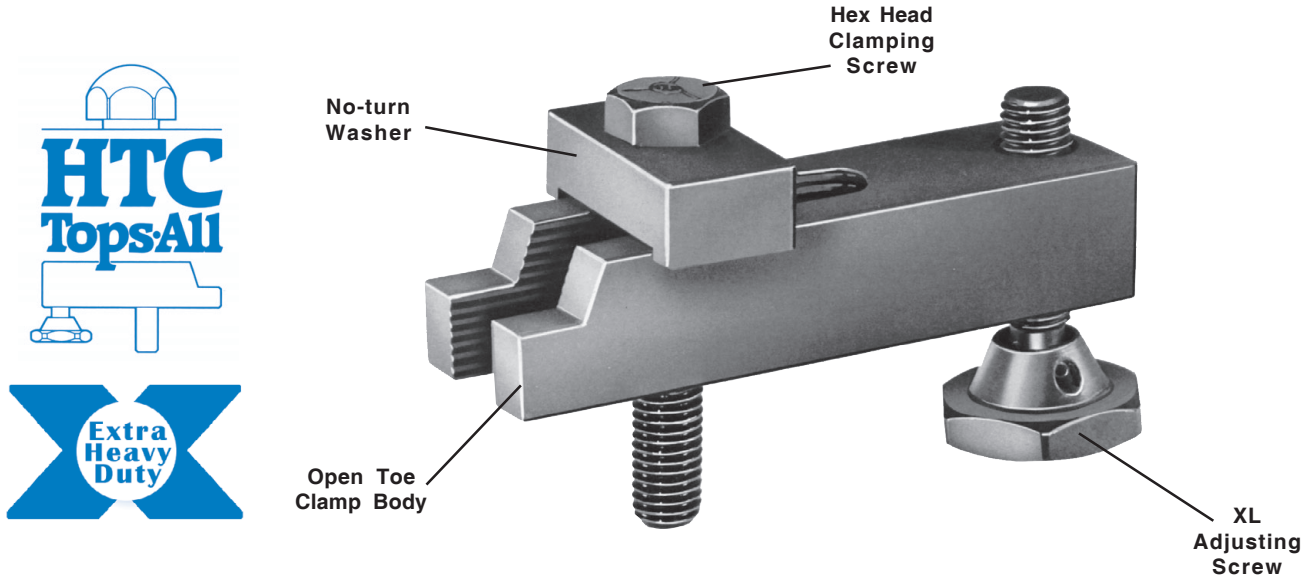

Also Available with Non-Swivel Base

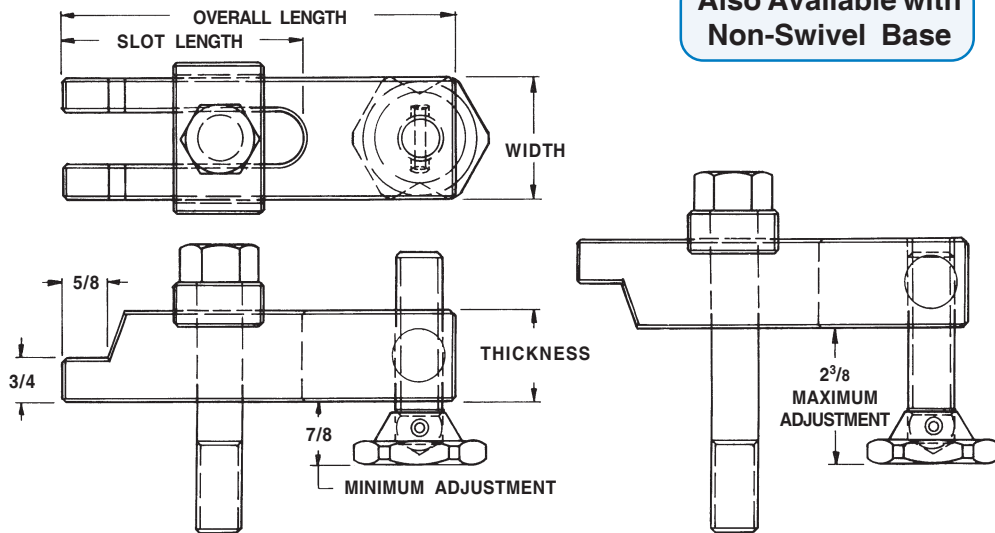

For Clamping Screw Diameter	Clamping Screw Size Supplied With Assembly (Diameter x Length)	Mold Clamp Body Specifications				Complete Assembly Part Number	Price Each	Individual Clamp Bodies Part Number	Price Each
		Thickness	Width	Slot Length	Overall Length				
5/8"	5/8"-11 x 3 3/4"	1 1/4"	1 3/4"	3 5/8"	6"	TAC-5860-A	\$40.00	XHD-5860	\$25.55
				4 5/8"	7 1/2"	TAC-5875-A	\$43.35	XHD-5875	\$29.00
3/4"	3/4"-10 x 4 1/2"	1 1/2"	2"	4"	6 1/2"	TAC-7565-A	\$54.15	XHD-7565	\$38.05
				5"	8"	TAC-7580-A	\$57.50	XHD-7580	\$40.05
				6"	9 1/2"	TAC-7595-A	\$61.35	XHD-7595	\$43.40
1"	1"-8 x 5 1/2"	1 3/4"	2 1/2"	4 3/8"	8"	TAC-1008-A	\$77.95	XHD-1008	\$45.90
				6 3/8"	11"	TAC-1011-A	\$85.10	XHD-1011	\$54.75

Machined Mold Clamps...continued

Closed Toe Style: Extra Heavy Duty (with Swivel-Base Adjusting Screw)

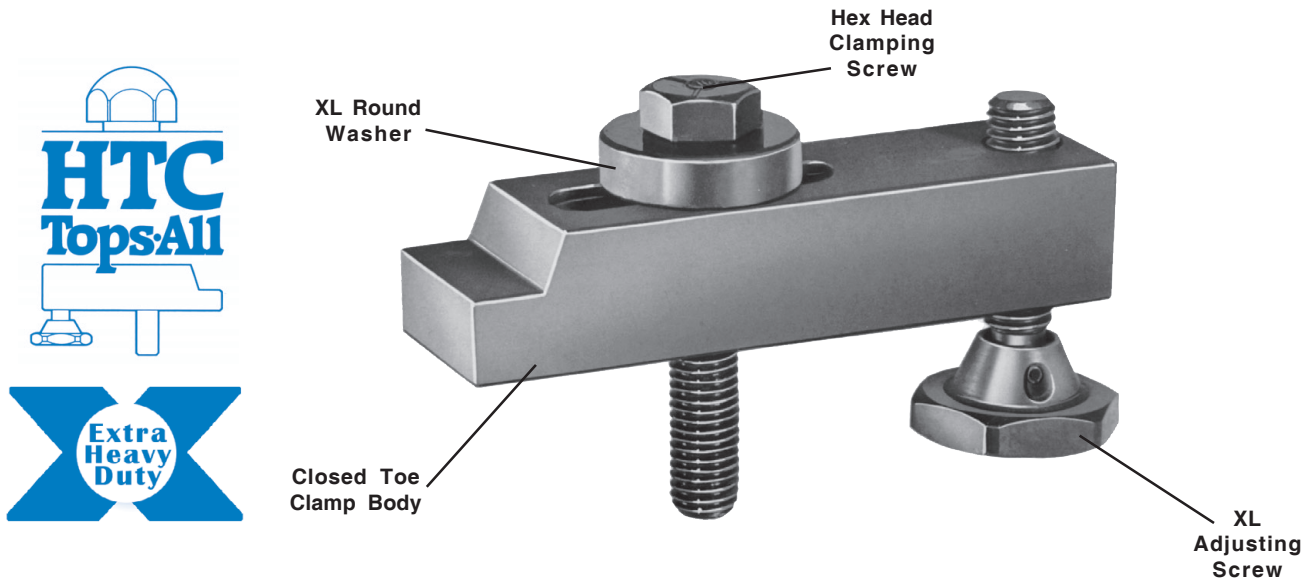

Also Available with Non-Swivel Base

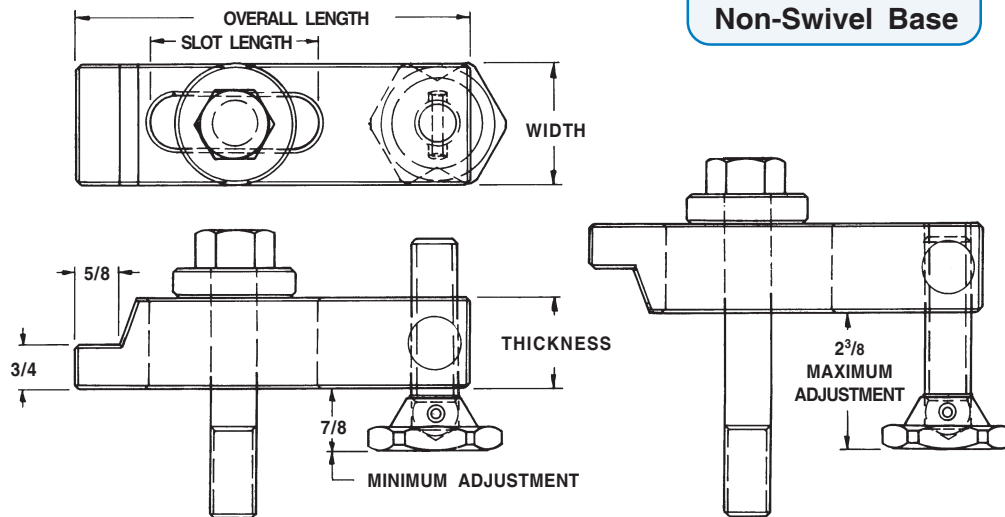

For Clamping Screw Diameter	Clamping Screw Size Supplied With Assembly (Diameter x Length)	Mold Clamp Body Specifications				Complete Assembly Part Number	Price Each	Individual Clamp Bodies Part Number	Price Each
		Thickness	Width	Slot Length	Overall Length				
5/8"	5/8"-11 x 3 3/4"	1 1/4"	1 3/4"	2 5/8"	6"	TAC-5861-A	\$40.05	XHD-5861	\$26.80
				3 5/8"	7 1/2"	TAC-5876-A	\$43.10	XHD-5876	\$29.85
3/4"	3/4"-10 x 4 1/2"	1 1/2"	2"	2 3/4"	6 1/2"	TAC-7566-A	\$55.55	XHD-7566	\$39.25
				3 3/4"	8"	TAC-7581-A	\$58.85	XHD-7581	\$42.55
				4 3/4"	9 1/2"	TAC-7596-A	\$62.45	XHD-7596	\$46.15
1"	1"-8 x 5 1/2"	1 3/4"	2 1/2"	3"	8"	TAC-1009-A	\$78.45	XHD-1009	\$48.65
				5"	11"	TAC-1012-A	\$87.05	XHD-1012	\$57.20
1 1/4"	1 1/4"-7 x 6"	1 3/4"	3"	5 1/2"	13"	TAC-1250-A	\$159.70	XHD-1250	\$104.15
1 1/2"	1 1/2"-6 x 6"	1 3/4"	3 1/2"	5 3/4"	13 1/2"	TAC-1500-A	\$176.55	XHD-1500	\$115.20

Machined Mold Clamps...continued

Open Toe Style: Heavy Duty (with Non-Swivel Base)

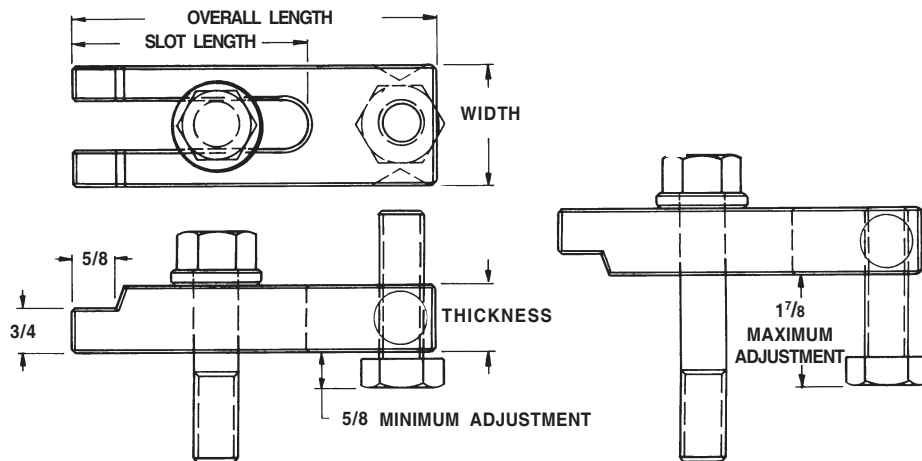
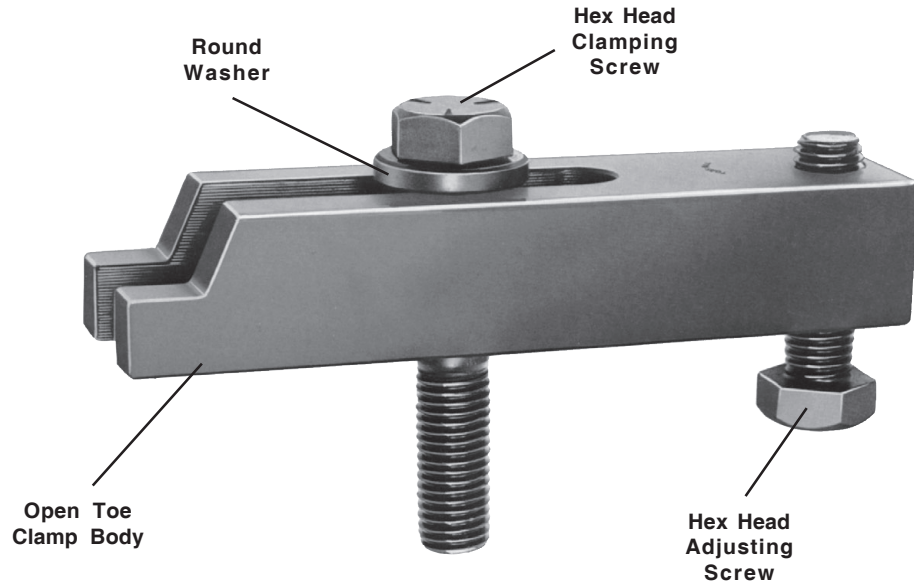

For Clamping Screw Diameter	Clamping Screw Size Supplied With Assembly (Diameter x Length)	Mold Clamp Body Specifications				Complete Assembly Part Number	Price Each	Individual Clamp Bodies Part Number	Price Each
		Thickness	Width	Slot Length	Overall Length				
5/8"	5/8"-11 x 3 1/4"	1"	1 3/4"	2 3/4"	4"	CFC-584-A	\$21.85	HD-584	\$17.40
				3 1/4"	5"	CFC-585-A	\$23.80	HD-585	\$19.35
				3 3/4"	6"	CFC-586-A	\$26.00	HD-586	\$21.55
				4 1/4"	7"	CFC-587-A	\$27.90	HD-587	\$23.80
3/4"	3/4"-10 x 4"	1 1/8"	2"	3 3/8"	5"	CFC-755-A	\$31.25	HD-755	\$24.05
				3 7/8"	6"	CFC-756-A	\$33.45	HD-756	\$26.25
				4 3/8"	7"	CFC-757-A	\$35.65	HD-757	\$28.45
				5 3/8"	8"	CFC-758-A	\$38.15	HD-758	\$30.95
1"	1"-8 x 4 1/2"	1 1/2"	2 1/2"	6"	10"	CFC-110-A	\$57.20	HD-110	\$42.30

Machined Mold Clamps...continued

Closed Toe Style - Extra Heavy Duty
 Designed For T-Slotted Machines (with Swivel-Base Adjusting Screw)

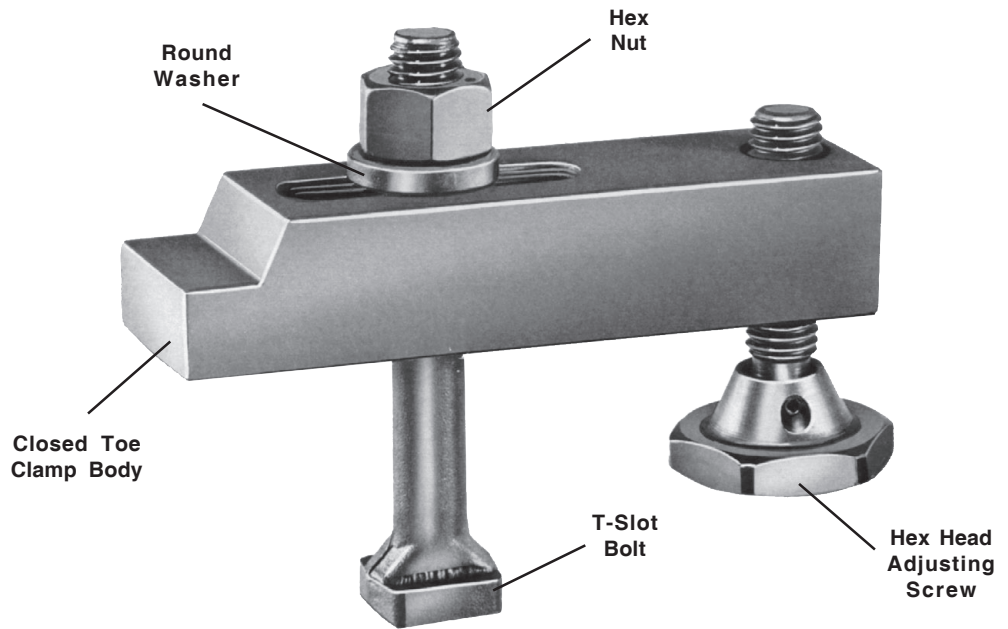

Also Available with
 Non-Swivel Base

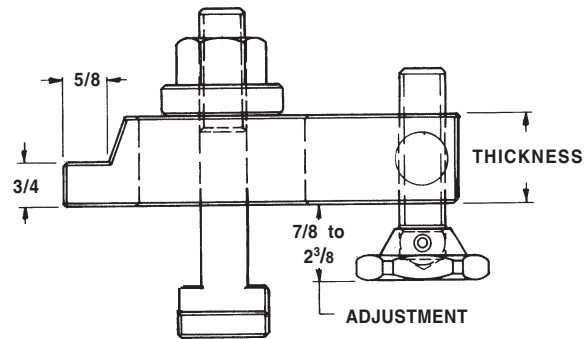
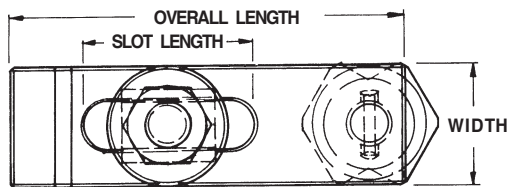

T-Slot Bolt Supplied With Assembly (Diameter x Length)	Mold Clamp Body Specifications				Complete Assembly Part Number	Price Each	Individual Clamp Bodies Part Number	Price Each
	Thickness	Width	Slot Length	Overall Length				
5/8" x 4 1/2"	1 1/4"	1 3/4"	2 5/8"	6"	TBA-5861-A	\$44.75	XHD-5861	\$26.80
3/4" x 5"	1 1/2"	2"	2 3/4"	6 1/2"	TBA-7566-A	\$62.75	XHD-7566	\$39.25
1" x 6"	1 3/4"	2 1/2"	3"	8"	TBA-1009-A	\$87.85	XHD-1009	\$48.65

Machined Mold Clamps - Replacement Parts

Individual Mold Clamp Bodies



All mold clamp bodies are made from hardened, premium Quality Steel. For specifications and part numbers, refer to mold clamp assembly charts.

Extra Large Adjusting Screw Assemblies



PART NO.	CLAMP SCREW DIAMETER	THREAD SIZE	SWIVEL BASE HEX SIZE	SWIVEL BASE HEIGHT	OVERALL HEIGHT	PRICE EACH
H-585	5/8"	5/8"-11	1 3/4"	7/8"	3"	\$9.55
H-755	3/4"	3/4"-10	2"	7/8"	3 1/2"	\$11.35
H-1005	1"	1"-8	2 1/2"	1 5/16"	3 1/2"	\$17.15
H-1505	1 1/4" and 1 1/2"	1 1/2"-6	3"	1 5/8"	5 5/8"	\$34.50

Hex Head Adjusting Screws



PART NO.	CLAMP SCREW DIAMETER	THREAD SIZE	HEAD THICKNESS	HEIGHT ABOVE HEAD	PRICE EACH
H-58	5/8"	5/8"-11	7/16"	2 1/2"	\$2.10
H-75	3/4"	3/4"-10	1/2"	2 1/2"	\$2.70
H-100	1"	1"-8	5/8"	2 1/2"	\$5.95

High Strength, Grade 5, Hex Head Clamping Screws



PART NO.	LENGTH	THREAD SIZE	HEX SIZE	THICKNESS	PRICE EACH
S-1235	3 1/2"	1/2"-13	3/4"	5/16"	\$1.80
S-5832	3 1/4"	5/8"-11	15/16"	25/64"	\$1.50
S-5835	3 1/2"	5/8"-11	15/16"	25/64"	\$1.80
S-5837	3 3/4"	5/8"-11	15/16"	25/64"	\$2.10
S-7540	4"	3/4"-10	1 1/8"	15/32"	\$3.00
S-7545	4 1/2"	3/4"-10	1 1/8"	15/32"	\$3.30
S-1045	4 1/2"	1"-8	1 1/2"	39/64"	\$7.45
S-1050	5"	1"-8	1 1/2"	39/64"	\$7.75
S-1055	5 1/2"	1"-8	1 1/2"	39/64"	\$8.35
S-1256	6"	1 1/4"-7	1 7/8"	3/4"	\$19.95
S-1506	6"	1 1/2"-6	2 1/4"	7/8"	\$24.40

Other Sizes Available Upon Request.

High Strength, T-Slot Bolts



PART NO.	LENGTH	THREAD SIZE	PRICE EACH
TB-5845	4 1/2"	5/8"-11	\$7.15
TB-7550	5"	3/4"-10	\$9.55
TB-1060	6"	1"-8	\$17.85

Machined Mold Clamps - Replacement Parts

Heavy Duty Hex Nuts for T-Slot Bolts



PART NO.	THREAD SIZE	HEX SIZE	THICKNESS	PRICE EACH
N-58	5/8"-11	1 1/16"	39/64"	\$1.80
N-75	3/4"-10	1 1/4"	47/64"	\$2.40
N-100	1"-8	1 5/8"	63/64"	\$3.30

Round Mold Washers



PART NO.	SCREW DIAMETER (I.D.)	DIAMETER (O.D.)	THICKNESS	PRICE EACH
RW-58	5/8"	1 1/4"	1/4"	\$1.50
RW-75	3/4"	1 1/2"	1/4"	\$2.40
RW-100	1"	2"	5/16"	\$3.60

Extra Large Round Mold Washers



PART NO.	SCREW DIAMETER (I.D.)	DIAMETER (O.D.)	THICKNESS	PRICE EACH
RW-586	5/8"	1 3/4"	1/2"	\$3.60
RW-756	3/4"	2"	1/2"	\$4.50
RW-1006	1"	2 1/2"	5/8"	\$6.85
RW-1256	1 1/4"	3"	5/8"	\$8.65
RW-1506	1 1/2"	3 1/2"	5/8"	\$10.75

Extra Large No-Twist Rectangular Washers

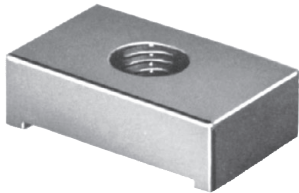

PART NO.	SCREW DIAMETER (I.D.)	LENGTH	THICKNESS ABOVE CLAMP	CLAMP WIDTH	PRICE EACH
SW-127	1/2"	2 1/4"	3/4"	1 1/4"	\$5.95
SW-587	5/8"	2 1/4"	3/4"	1 1/4"	\$5.40
SW-757	3/4"	2 1/2"	3/4"	1 1/2"	\$5.95
SW-1007	1"	3"	1"	2"	\$8.65

Open Toe Clamp Limited Guarantee

Though manufactured using superior craftsmanship and outstanding quality, open toe clamps cannot be returned if broken during use due to the nature of their design.