

Pipe Fittings - Brass & Galvanized

Templates:

(For Proper Size Selection: NPT actual O.D. measurement is approximately 1/4" larger than NPT size.)



1/16
NPT



1/8
NPT



1/4
NPT



3/8
NPT



1/2
NPT

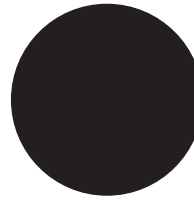

3/4
NPT

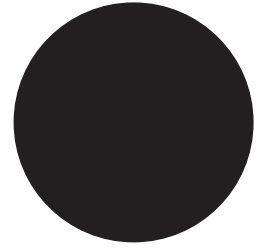

1
NPT

NOTE: When ordering pipe fittings, add "B" to the part number for Brass, or "G" for Galvanized, to ensure proper part delivery. FOR EXAMPLE: To order a galvanized 1/8 NPT Square Head Plug, request part number SP18G.

Square Head Plug

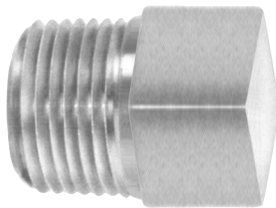

PART NO.	NPT THREAD SIZE	PRICE EACH			
		BRASS		GALVANIZED	
		1-24	25+	1-24	25+
SP18__*	1/8	Call for Pricing 800-627-1033			
SP14__*	1/4				
SP38__*	3/8				
SP12__*	1/2				
SP34__*^	3/4				
SP1__*^	1				

*Add "B" to part number for Brass (^Bronze), "G" for Galvanized

Bushing

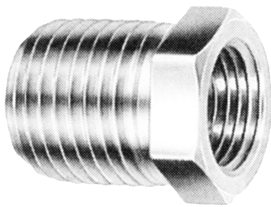

PART NO.	NPT THREAD SIZE (M x F)	PRICE EACH			
		BRASS		GALVANIZED	
		1-24	25+	1-24	25+
B14X18__*	1/4 x 1/8	Call for Pricing 800-627-1033			
B38X18__*^	3/8 x 1/8				
B38X14__*	3/8 x 1/4				
B12X18__*	1/2 x 1/8				
B12X14__*	1/2 x 1/4				
B12X38__*	1/2 x 3/8				
B34X18__*^	3/4 x 1/8				
B34X14__*^	3/4 x 1/4				
B34X38__*^	3/4 x 3/8				
B34X12__*	3/4 x 1/2				
B1X14__*^	1 x 1/4				
B1X38__*^	1 x 3/8				
B1X12__*^	1 x 1/2				
B1X34__*^	1 x 3/4				
B114X34__*^	1 1/4 x 3/4				
B114X1__*^	1 1/4 x 1				
B112X1__*^	1 1/2 x 1				

*Add "B" to part number for Brass (^Bronze), "G" for Galvanized.

Hex Nipple

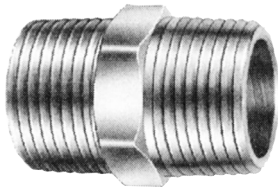

PART NO.	NPT THREAD SIZE	PRICE EACH			
		BRASS		GALVANIZED	
		1-24	25+	1-24	25+
HN18B	1/8	Call for Pricing 800-627-1033			
HN14B	1/4				
HN38B	3/8				
HN12B	1/2				
HN34B	3/4				
HN1B^	1				

^Bronze

Male Reducing Hex Nipple

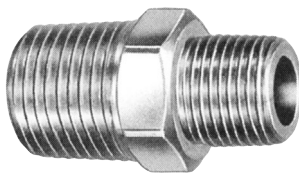

PART NO.	NPT THREAD SIZE	PRICE EACH			
		BRASS		GALVANIZED	
		1-24	25+	1-24	25+
MR18116B	1/8 x 1/16	Call for Pricing 800-627-1033			
MR1418B	1/4 x 1/8				
MR3818B	3/8 x 1/8				
MR3814B	3/8 x 1/4				
MR1214B	1/2 x 1/4				
MR1238B	1/2 x 3/8				
MR3412B	3/4 x 1/2				

Adapter

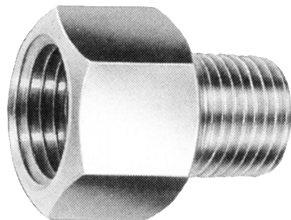

PART NO.	NPT THREAD SIZE F x M	PRICE EACH			
		BRASS		GALVANIZED	
		1-24	25+	1-24	25+
A18X18B	1/8 x 1/8	Call for Pricing 800-627-1033			
A14X18B	1/4 x 1/8				
A14X14B	1/4 x 1/4				
A38X18B	3/8 x 1/8				
A38X14B	3/8 x 1/4				
A38X38B	3/8 x 3/8				
A12X14B	1/2 x 1/4				
A12X38B	1/2 x 3/8				
A12X12B	1/2 x 1/2				
A34X38B	3/4 x 3/8				
A34X12B	3/4 x 1/2				
A34X34B	3/4 x 3/4				

Union

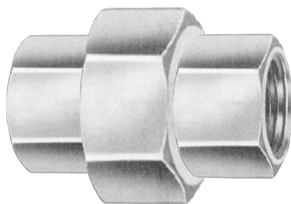

PART NO.	NPT THREAD SIZE	PRICE EACH			
		BRASS		GALVANIZED	
		1-24	25+	1-24	25+
U18__^	1/8	Call for Pricing 800-627-1033			
U14__^	1/4				
U38__^	3/8				
U12__^	1/2				
U34__^	3/4				
U1__^	1				
U112__^	1 1/2				

*Add "B" to part number for Brass (^Bronze), "G" for Galvanized.

Male Branch

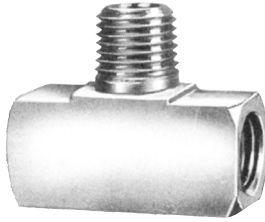

PART NO.	NPT THREAD SIZE	PRICE EACH			
		BRASS		GALVANIZED	
		1-24	25+	1-24	25+
MB18B	1/8	Call for Pricing 800-627-1033			
MB14B	1/4				
MB38B	3/8				
MB12B	1/2				
MB34B	3/4				

Female Pipe Tee

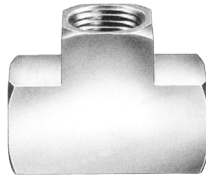

PART NO.	NPT THREAD SIZE	PRICE EACH			
		BRASS		GALVANIZED	
		1-24	25+	1-24	25+
FPT18__*	1/8	Call for Pricing 800-627-1033			
FPT14__*^	1/4				
FPT38__*^	3/8				
FPT12__*^	1/2				
FPT34__*^	3/4				
FPT1__*^	1				

**Add "B" to part number for Brass (^Bronze), "G" for Galvanized.*

Coupling - Female

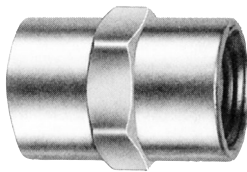

PART NO.	NPT THREAD SIZE	PRICE EACH			
		BRASS		GALVANIZED	
		1-24	25+	1-24	25+
C18__*	1/8	Call for Pricing 800-627-1033			
C14__*	1/4				
C38__*	3/8				
C12__*	1/2				
C34__*^	3/4				
C1__*^	1				

**Add "B" to part number for Brass (^Bronze), "G" for Galvanized.*

Reducing Coupling - Female

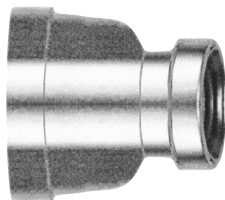

PART NO.	NPT THREAD SIZE	PRICE EACH			
		BRASS		GALVANIZED	
		1-24	25+	1-24	25+
RC1418__*^	1/4 x 1/8	Call for Pricing 800-627-1033			
RC3818__*^	3/8 x 1/8				
RC3814__*^	3/8 x 1/4				
RC1218__*^	1/2 x 1/8				
RC1214__*^	1/2 x 1/4				
RC1238__*^	1/2 x 3/8				
RC3414__*^	3/4 x 1/4				
RC3438__*^	3/4 x 3/8				
RC3412__*^	3/4 x 1/2				
RC112__*^	1 x 1/2				
RC134__*^	1 x 3/4				
RC1121__*^	1 1/2 x 1				
RC2112__*^	2 x 1 1/2				

**Add "B" to part number for Brass (^Bronze), "G" for Galvanized.*

45° Street Elbow

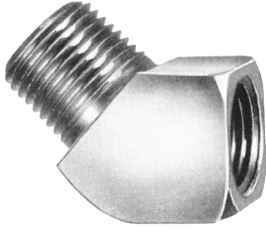

PART NO.	NPT THREAD SIZE	PRICE EACH			
		BRASS		GALVANIZED	
		1-24	25+	1-24	25+
45SE18__*	1/8	Call for Pricing 800-627-1033			
45SE14__*	1/4				
45SE38__^A	3/8				
45SE12__^A	1/2				
45SE34__^A	3/4				

*Add "B" to part number for Brass (^Bronze), "G" for Galvanized.

45° Elbow - Female

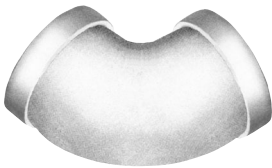

PART NO.	NPT THREAD SIZE	PRICE EACH			
		BRASS		GALVANIZED	
		1-24	25+	1-24	25+
E45-18__^A	1/8	Call for Pricing 800-627-1033			
E45-14__^A	1/4				
E45-38__^A	3/8				
E45-12__^A	1/2				
E45-34__^A	3/4				
E45-1__^A	1				

*Add "B" to part number for Brass (^Bronze), "G" for Galvanized.

90° Street Elbow

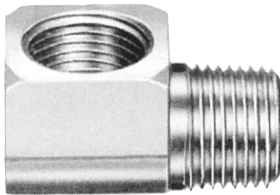

PART NO.	NPT THREAD SIZE	PRICE EACH			
		BRASS		GALVANIZED	
		1-24	25+	1-24	25+
90SE18X18__*	1/8 x 1/8	Call for Pricing 800-627-1033			
90SE14X18B^	1/4 x 1/8				
90SE14X14__*	1/4 x 1/4				
90SE38X38__^A	3/8 x 3/8				
90SE12X12__^A	1/2 x 1/2				
90SE34X34__^A	3/4 x 3/4				
90SE1X1__^A	1 x 1				

*Add "B" to part number for Brass (^Bronze), "G" for Galvanized.

90° Elbow - Female

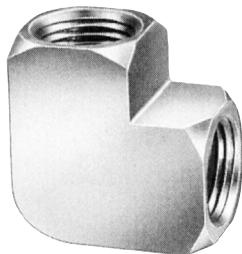

PART NO.	NPT THREAD SIZE	PRICE EACH			
		BRASS		GALVANIZED	
		1-24	25+	1-24	25+
E90-18__*	1/8	Call for Pricing 800-627-1033			
E90-14__*	1/4				
E90-38__^A	3/8				
E90-12__^A	1/2				
E90-34__^A	3/4				
E90-1__^A	1				
E90-112__^A	1½				
E90-14X18__^A	1/4 x 1/8				
E90-38X14__^A	3/8 x 1/4				
E90-12X38__^A	1/2 x 3/8				

*Add "B" to part number for Brass (^Bronze), "G" for Galvanized.

Pipe Caps

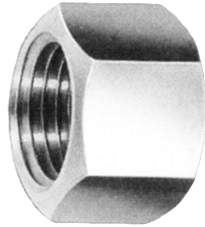

PART NO.	NPT THREAD SIZE	PRICE EACH			
		BRASS		GALVANIZED	
		1-24	25+	1-24	25+
PC18__ ^{*^}	1/8	Call for Pricing 800-627-1033			
PC14__ ^{*^}	1/4				
PC38__ ^{*^}	3/8				
PC12__ ^{*^}	1/2				
PC34__ ^{*^}	3/4				
PC1__ ^{*^}	1				
PC114__ ^{*^}	1¼				
PC112__ ^{*^}	1½				
PC2__ ^{*^}	2				

**Add "B" to part number for Brass (^Bronze), "G" for Galvanized.*

Pipe Crosses

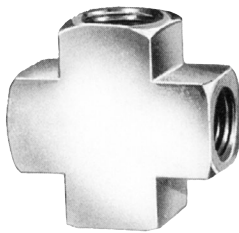

PART NO.	NPT THREAD SIZE	PRICE EACH			
		BRASS		GALVANIZED	
		1-24	25+	1-24	25+
CR14__ ^{*^}	1/4	Call for Pricing 800-627-1033			
CR38__ ^{*^}	3/8				
CR12__ ^{*^}	1/2				
CR34__ ^{*^}	3/4				
CR1__ ^{*^}	1				
CR114__ ^{*^}	1¼				
CR112__ ^{*^}	1½				
CR2__ ^{*^}	2				

**Add "B" to part number for Brass (^Bronze), "G" for Galvanized.*

Counter Sunk Hex Head Plug



PART NO.	NPT THREAD SIZE	PRICE EACH			
		BRASS		GALVANIZED	
		1-24	25+	1-24	25+
P116B	1/16	Call for Pricing 800-627-1033			
P18__ [*]	1/8				
P14__ [*]	1/4				
P38__ [*]	3/8				
P12__ ^{*^}	1/2				
P34__ ^{*^ 1}	3/4				
P1__ ^{*^ 1}	1				

**Add "B" to part number for Brass (^Bronze), "G" for Galvanized. ¹Square head.*

Mold Pressure Plugs

- Finest Quality - Made in the U.S.A.
- Standard Plugs are Flush Type (7/8 taper); Oversize Plugs (3/4 taper) also available.



PART NO.	NPT THREAD SIZE	PRICE EACH			
		Call for Pricing 800-627-1033			
MPP116B*	1/16				
MPP18B*	1/8				
MPP14B*	1/4				
MPP38B*	3/8				
MPP12B*	1/2				
MPP34B*	3/4				
MPP1B*	1				
MPP114B*	1¼				
MPP112B*	1½				
MPP2B*	2				

**Also available in Stainless Steel.*

Close Nipple

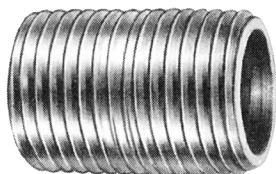

PART NO.	NPT THREAD SIZE	PRICE EACH			
		BRASS		GALVANIZED	
		1-24	25+	1-24	25+
CN116B	1/16	Call for Pricing 800-627-1033			
CN18 *	1/8				
CN14 *	1/4				
CN38 *	3/8				
CN12 *	1/2				
CN34 *	3/4				
CN1 *	1				
CN114 *	1 1/4				
CN112 *	1 1/2				

*Add "B" to part number for Brass, "G" for Galvanized.

Long Nipple

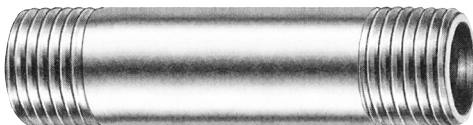

PART NO.	O.A.L.	PRICE EACH		PART NO.	O.A.L.	PRICE EACH		PART NO.	O.A.L.	PRICE EACH	
		BRASS				BRASS				BRASS	
		1-24	25+			1-24	25+			1-24	25+
1/16 NPT			3/8 NPT			1 NPT					
LN116X112B	1 1/2"	Call for Pricing 800-627-1033		LN38X112_ *	1 1/2"	Call for Pricing 800-627-1033		N/A	1 1/2"	Call for Pricing 800-627-1033	
LN116X2B	2"			LN38X2_ *	2"			LN1X2_ *	2"		
LN116X3B	3"			LN38X3_ *	3"			LN1X3_ *	3"		
LN116X4B	4"			LN38X4_ *	4"			LN1X4_ *	4"		
LN116X5B	5"			LN38X5_ *	5"			LN1X5_ *	5"		
LN116X6B	6"			LN38X6_ *	6"			LN1X6_ *	6"		
LN116X7B	7"			LN38X7_ *	7"			LN1X7_ *	7"		
LN116X8B	8"			LN38X8_ *	8"			LN1X8_ *	8"		
LN116X9B	9"			LN38X9_ *	9"			LN1X9_ *	9"		
LN116X10B	10"			LN38X10_ *	10"			LN1X10_ *	10"		
LN116X11B	11"			LN38X11_ *	11"			LN1X11_ *	11"		
LN116X12B	12"			LN38X12_ *	12"			LN1X12_ *	12"		
1/8 NPT			1/2 NPT			1 1/4 NPT					
LN18X112_ *	1 1/2"	Call for Pricing 800-627-1033		LN12X112_ *	1 1/2"	Call for Pricing 800-627-1033		N/A	1 1/2"	Call for Pricing 800-627-1033	
LN18X2_ *	2"			LN12X2_ *	2"			LN114X2_ *	2"		
LN18X3_ *	3"			LN12X3_ *	3"			LN114X3_ *	3"		
LN18X4_ *	4"			LN12X4_ *	4"			LN114X4_ *	4"		
LN18X5_ *	5"			LN12X5_ *	5"			LN114X5_ *	5"		
LN18X6_ *	6"			LN12X6_ *	6"			LN114X6_ *	6"		
LN18X7_ *	7"			LN12X7_ *	7"			LN114X7_ *	7"		
LN18X8_ *	8"			LN12X8_ *	8"			LN114X8_ *	8"		
LN18X9_ *	9"			LN12X9_ *	9"			LN114X9_ *	9"		
LN18X10_ *	10"			LN12X10_ *	10"			LN114X10_ *	10"		
LN18X11_ *	11"			LN12X11_ *	11"			LN114X11_ *	11"		
LN18X12_ *	12"			LN12X12_ *	12"			LN114X12_ *	12"		
1/4 NPT			3/4 NPT			1 1/2 NPT					
LN14X112_ *	1 1/2"	Call for Pricing 800-627-1033		LN34X112_ *	1 1/2"	Call for Pricing 800-627-1033		N/A	1 1/2"	Call for Pricing 800-627-1033	
LN14X2_ *	2"			LN34X2_ *	2"			LN112X2_ *	2"		
LN14X3_ *	3"			LN34X3_ *	3"			LN112X3_ *	3"		
LN14X4_ *	4"			LN34X4_ *	4"			LN112X4_ *	4"		
LN14X5_ *	5"			LN34X5_ *	5"			LN112X5_ *	5"		
LN14X6_ *	6"			LN34X6_ *	6"			LN112X6_ *	6"		
LN14X7_ *	7"			LN34X7_ *	7"			LN112X7_ *	7"		
LN14X8_ *	8"			LN34X8_ *	8"			LN112X8_ *	8"		
LN14X9_ *	9"			LN34X9_ *	9"			LN112X9_ *	9"		
LN14X10_ *	10"			LN34X10_ *	10"			LN112X10_ *	10"		
LN14X11_ *	11"			LN34X11_ *	11"			LN112X11_ *	11"		
LN14X12_ *	12"			LN34X12_ *	12"			LN112X12_ *	12"		

*Add "B" to part number for Brass, "G" for Galvanized.

Also available in Stainless Steel. Call for information and pricing.





7925 N. Clinton St., Fort Wayne, IN 46825 USA • Web: www.servicesforplastics.com • E-mail: sales@servicesforplastics.com
Toll Free Phone: 800-627-1033 • Fax: 800-482-4059 • Local Phone: 260-482-9211 • Fax: 260-483-8139

Brass Hose Barbs

Standard Hose Barbs

FOR USE WITH:

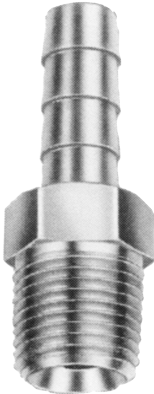
- Air
- Water
- Oil

STANDARD HOSE BARB	PART NO.	HOSE I.D.	NPT	PRICE EACH	
				1-24	25+
MALE PIPE THREAD 	M1418	1/4"	1/8	Call for Pricing 800-627-1033 Call for Pricing 800-627-1033 Call for Pricing 800-627-1033 Call for Pricing 800-627-1033 Call for Pricing 800-627-1033	
	M1414	1/4"	1/4		
	M1438	1/4"	3/8		
	M1412	1/4"	1/2		
	M51618	5/16"	1/8		
	M51614	5/16"	1/4		
	M51638	5/16"	3/8		
	M51612	5/16"	1/2		
	M3818	3/8"	1/8		
	M3814	3/8"	1/4		
	M3838	3/8"	3/8		
	M3812	3/8"	1/2		
	M3834	3/8"	3/4		
	M1214	1/2"	1/4		
	M1238	1/2"	3/8		
	M1212	1/2"	1/2		
	M1234	1/2"	3/4		
	M5814	5/8"	1/4		
	M5838	5/8"	3/8		
	M5812	5/8"	1/2		
	M5834	5/8"	3/4		
	M3438	3/4"	3/8		
	M3412	3/4"	1/2		
	M3434	3/4"	3/4		
	M341	3/4"	1		
	M112	1"	1/2		
	M134	1"	3/4		
	M11	1"	1		
M1141	1 1/4"	1			
FEMALE PIPE THREAD 	F1418	1/4"	1/8	Call for Pricing 800-627-1033 Call for Pricing 800-627-1033	
	F1414	1/4"	1/4		
	F1438	1/4"	3/8		
	F51618	5/16"	1/8		
	F51614	5/16"	1/4		
	F51638	5/16"	3/8		
	F3818	3/8"	1/8		
	F3814	3/8"	1/4		
	F3838	3/8"	3/8		
	F3812	3/8"	1/2		
	F1214	1/2"	1/4		
	F1238	1/2"	3/8		
	F1212	1/2"	1/2		
	F3434	3/4"	3/4		
HOSE SPLICERS 	S14	1/4"	-	800-627-1033	
	S516	5/16"	-		
	S38	3/8"	-		
	S12	1/2"	-		
	S58	5/8"	-		
	S34	3/4"	-		
	S1	1"	-		

*For Use with
Hose Clamps*



*Excellent for use
with our Air-Water-Oil
Hoses:*

Hose

- GST® II GS
- Grizzly™ Hose
- PVC Hose

Standard Hose Barbs

FOR USE WITH:

- Air
- Water
- Oil

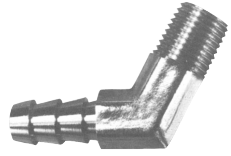
45° BARB ELBOW	PART NO.	HOSE I.D.	NPT	PRICE EACH			
				1-24	25+		
	MALE PIPE THREAD			45BBE14X18	1/4"	1/8	Call for Pricing 800-627-1033
	45BBE14X14	1/4"	1/4				
	45BBE38X18	3/8"	1/8				
	45BBE38X14	3/8"	1/4				
	45BBE38X38	3/8"	3/8				
	45BBE12X14	1/2"	1/4				
	45BBE12X38	1/2"	3/8				
	45BBE58X38	5/8"	3/8				

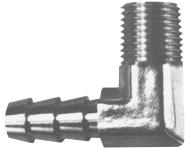
90° BARB ELBOW	PART NO.	HOSE I.D.	NPT	PRICE EACH			
				1-24	25+		
	MALE PIPE THREAD			90BBE14X18	1/4"	1/8	Call for Pricing 800-627-1033
	90BBE14X14	1/4"	1/4				
	90BBE14X38	1/4"	3/8				
	90BBE516X18	5/16"	1/8				
	90BBE516X14	5/16"	1/4				
	90BBE516X38	5/16"	3/8				
	90BBE38X18	3/8"	1/8				
	90BBE38X14	3/8"	1/4				
	90BBE38X38	3/8"	3/8				
	90BBE38X12	3/8"	1/2				
	90BBE12X14	1/2"	1/4				
	90BBE12X38	1/2"	3/8				
	90BBE12X12	1/2"	1/2				

For Use with Hose Clamps





Push-Lock Hose Barbs

FOR USE WITH:

- Air
- Water
- Oil

If used with our Jiffy Hose™ (7212 Series) or other push-on hose, no hose clamps are needed!

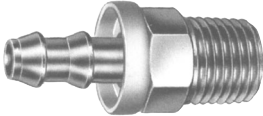
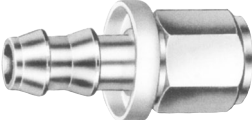

PUSH-LOCK HOSE BARB	PART NO.	HOSE I.D.	NPT	PRICE EACH			
				1-24	25+		
	MALE PIPE THREAD			M1418PL	1/4"	1/8	Call for Pricing 800-627-1033
	M1414PL	1/4"	1/4				
	M1438PL	1/4"	3/8				
	M3818PL	3/8"	1/8				
	M3814PL	3/8"	1/4				
	M3838PL	3/8"	3/8				
	M3812PL	3/8"	1/2				
	M1214PL	1/2"	1/4				
	M1238PL	1/2"	3/8				
	M1212PL	1/2"	1/2				
	FEMALE PIPE THREAD			F1418PL	1/4"	1/8	Call for Pricing 800-627-1033
	F1414PL	1/4"	1/4				
	F1438PL	1/4"	3/8				
	F3818PL	3/8"	1/8				
	F3814PL	3/8"	1/4				
	F3838PL	3/8"	3/8				
	F3812PL	3/8"	1/2				
	F1214PL	1/2"	1/4				
	F1238PL	1/2"	3/8				
F1212PL	1/2"	1/2					
	HOSE SPLICERS			S14PL	1/4"	-	
	S38PL	3/8"	-				
	S12PL	1/2"	-				
	S34PL	3/4"	-				

Brass Adjustable Hex Nipples

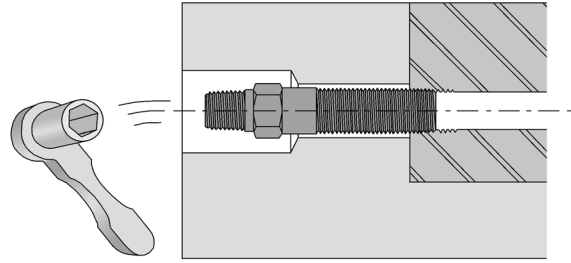
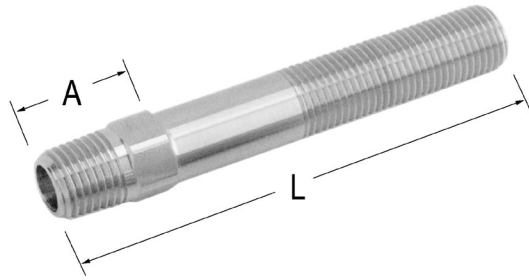

FEATURES:

- Adjustable Threads for Perfect Positioning
- Standard NPT Tapered Pipe Threads Both Ends
- Especially Useful When Installing Cascade Heads, Hex Elbows, etc. Inside Molds and Slides
- Longer or Special Exact Lengths Available
- Also Available in Special Thread Combinations



PART NO.	PIPE SIZE (NPT)	"A"	HEX SIZE	OVERALL LENGTH "L"						
				2½"	4"	5½"	7"	8½"	10"	11½"
APN16-__*	1/16	11/16"	3/8	Call for Pricing 800-627-1033						
APN18-__*	1/8	3/4"	7/16							
APN14-__*	1/4	7/8"	9/16							
APN38-__*	3/8	1"	11/16							
APN12-__*	1/2	1 3/8"	7/8							

*To order, insert desired overall length; Example: APN14- 212

Hydraulic Couplers

MANUAL TYPE - Available in Steel or Brass

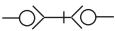
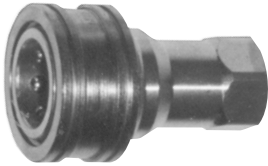
Standard Seals: Buna-N (-40°F to +225°F). Available with Viton, Neoprene, EPDM and Silicone Seals.

 2-Way Shut-Off		BODY SIZE	NPT	STEEL		BRASS	
				PART NO.	PRICE	PART NO.	PRICE
SOCKETS		1/8"	1/8	HC1818	Call for Pricing	HC1818B	
		1/4"	1/4	HC1414		HC1414B	
		3/8"	3/8	HC3838		HC3838B	
		1/2"	1/2	HC1212		HC1212B	
		3/4"	3/4	HC3434		HC3434B	
		1"	1	HC11		HC11B	
		1 1/4"	1 1/4"	HC114114		HC114114B	
		1 1/2"	1 1/2"	HC112112		HC112112B	
PLUGS		1/8"	1/8	HP1818	800-627-1033	HP1818B	
		1/4"	1/4	HP1414		HP1414B	
		3/8"	3/8	HP3838		HP3838B	
		1/2"	1/2	HP1212		HP1212B	
		3/4"	3/4	HP3434		HP3434B	
		1"	1	HP11		HP11B	
		1 1/4"	1 1/4"	HP114114		HP114114B	
		1 1/2"	1 1/2"	HP112112		HP112112B	

Plastic Dust Plugs for Sockets

PART NO.	BODY SIZE	PRICE EACH
HC1818DP	1/8"	Call for Pricing
HC1414DP	1/4"	
HC3838DP*	3/8"	
HC1212DP	1/2"	
HC3434DP	3/4"	
HC11DP	1"	
HC114114DP*	1 1/4"	
HC112112DP*	1 1/2"	

*Machined Aluminum

Plastic Dust Caps for Plugs

PART NO.	BODY SIZE	PRICE EACH
HP1818DC	1/8"	Call for Pricing
HP1414DC	1/4"	
HP3838DC	3/8"	
HP1212DC	1/2"	
HP3434DC	3/4"	
HP11DC	1"	
HP114114DC*	1 1/4"	
HP112112DC*	1 1/2"	

*Machined Aluminum

Interchangeability Chart

SFP	RECTUS	AEROQUIP		AMFLO			FOSTER		HANSEN	PERFECTING	PARKER		TOMCO
Steel (Brass)	Brass	Brass	Steel	Steel	Brass	Steel	(B)1-H11	1HF1(B)	BH1-60	H1-62	TH1-11(-002)		
COUPLERS													
HC1818(B)	HK2-712B-M	FD45-1101-02-02	FD45-1003-02-02	C161	H1B	H1S	(B)2-H16	2HF2(B)	BH2-60	H2-62	TH2-16(-002)		
HC1414(B)	HK2-722D-M	FD45-1101-04-04	FD45-1003-04-04	C162	H2B	H2S	(B)3-H21	3HF3(B)	BH3-60	H3-62	TH3-21(-002)		
HC3838(B)	HK2-732F-M	FD45-1101-06-06	FD45-1003-06-06	C163	H3B	H3S	(B)4-H26	4HF4(B)	BH4-60	H4-62	TH4-26(-002)		
HC1212(B)	HK2-742G-M	FD45-1101-08-10	FD45-1003-08-10	C164	H4B	H4S	(B)6-H31	6HF6(B)	BH6-60	H6-62	TH6-31(-002)		
HC3434(B)	HK2-752H-M	FD45-1101-12-12	FD45-1003-12-12	C166	H6B	H6S	(B)8-H36	8HF8(B)	BH8-60	H8-62	TH8-36(-002)		
HC11(B)	-	FD45-1101-16-16	FD45-1003-16-16	C168	H8B	H8S							
PLUGS													
HP1818(B)	HN2-712B-M	FD45-1086-02-02	FD45-1002-02-02	CP161	K1B	K1S	(B)2-K16	H2F2(B)	BH2-61	H2-63	TK2-16(-002)		
HP1414(B)	HN2-722D-M	FD45-1086-04-04	FD45-1002-04-04	CP162	K2B	K2S	(B)3-K21	H3F3(B)	BH3-61	H3-63	TK3-21(-002)		
HP3838(B)	HN2-732F-M	FD45-1086-06-06	FD45-1002-06-06	CP163	K3B	K3S	(B)4-K26	H4F4(B)	BH4-61	H4-63	TK4-26(-002)		
HP1212(B)	HN2-742G-M	FD45-1086-08-10	FD45-1002-08-10	CP164	K4B	K4S	(B)6-K31	H6F6(B)	BH6-61	H6-63	TK6-31(-002)		
HP3434(B)	HN2-752H-M	FD45-1086-12-12	FD45-1002-12-12	CP166	K6B	K6S							
HP11(B)	-	FD45-1086-16-16	FD45-1002-16-16	CP168	K8B	K8S							



Extended Brass Plugs

Designed to eliminate the installation problems of soldering, welding, etc. of connector plugs to steel pipe nipples. Once installed, the advantages of flush mounted mold connector plugs are many. Sealing surfaces of plugs are protected, while handling and storage of the mold is made easier.

- Length Adjustments are Easy With A Pre-cut Thread System
- 1-piece Construction for Fast Assembly, Positive Removal
- Available in Brass, Stainless, or Plated Steel
- Compatible with All Major Mold Connection Systems
- End Threads Tapered for Standard NPT Pipe Assembly

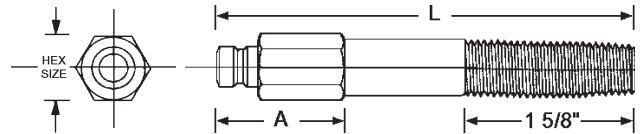
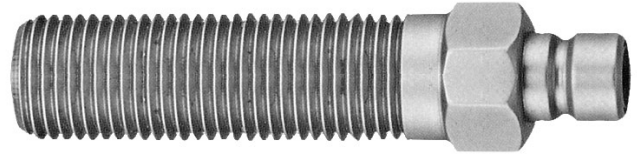

Length Adjustments & Installation

1. When special length adjustments are required, simply cut piece to length and chamfer end.

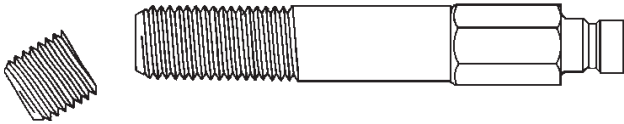

2. Turn into standard pipe threading die to re-taper threads.

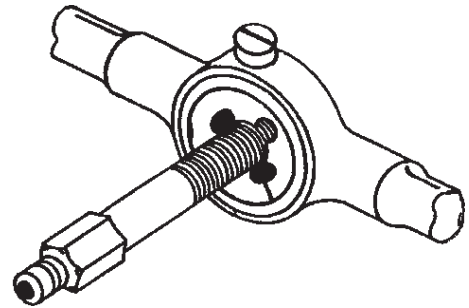

3. At assembly, the tapered brass threads provide a dependable leak-proof seal. With one-piece construction, removability is always guaranteed.

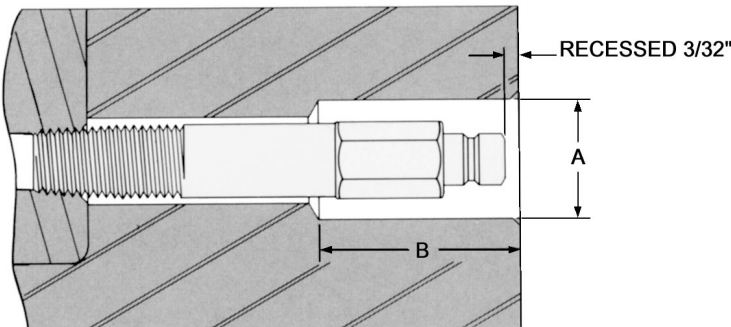

EXTENSION SERIES	"A"	"B"
250	3/4"	1"
251	7/8"	1 1/4"
252	1"	1 1/2"
253	1 1/8"	1 1/2"
350	1"	1 1/4"
351	1"	1 1/4"
352	1"	1 1/2"
353	1 1/8"	1 1/2"
354	1 1/2"	1 3/4"
553	1 3/8"	1 5/8"
554	1 1/2"	1 3/4"

Extended Brass Plugs

200 Series



1/4" Hole (Actual Size)

PART NO.	"L"	HEX SIZE	"A"	PRICE EACH
1/16" Pipe Size				
PSE-250X2.5	2½"	3/8"	11/16"	Call for Pricing
PSE-250X4	4"	3/8"	13/16"	
PSE-250X5.5	5½"	3/8"	13/16"	
PSE-250X7	7"	3/8"	13/16"	
1/8" Pipe Size				
PSE-251X2.5	2½"	7/16"	11/16"	Call for Pricing
PSE-251X4	4"	7/16"	1"	
PSE-251X5.5	5½"	7/16"	1"	
PSE-251X7	7"	7/16"	1"	
PSE-251X8.5	8½"	7/16"	1"	
PSE-251X10	10"	7/16"	1"	
PSE-251X11.5	11½"	7/16"	1"	
PSE-251X13	13"	7/16"	1"	
1/4" Pipe Size				
PSE-252X2.5	2½"	9/16"	7/8"	Call for Pricing
PSE-252X4	4"	9/16"	1¼"	
PSE-252X5.5	5½"	9/16"	1¼"	
PSE-252X7	7"	9/16"	1¼"	
PSE-252X8.5	8½"	9/16"	1¼"	
PSE-252X10	10"	9/16"	1¼"	
PSE-252X11.5	11½"	9/16"	1¼"	
PSE-252X13	13"	9/16"	1¼"	
3/8" Pipe Size				
PSE-253X2.5	2½"	11/16"	1"	Call for Pricing
PSE-253X4	4"	11/16"	1¼"	
PSE-253X5.5	5½"	11/16"	1¼"	
PSE-253X7	7"	11/16"	1¼"	
PSE-253X8.5	8½"	11/16"	1¼"	
PSE-253X10	10"	11/16"	1¼"	
PSE-253X11.5	11½"	11/16"	1¼"	
PSE-253X13	13"	11/16"	1¼"	
1/2" Pipe Size				
Available on request.				

300 Series

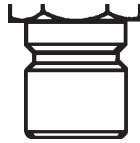

3/8" Hole (Actual Size)

PART NO.	"L"	HEX SIZE	"A"	PRICE EACH
1/16" Pipe Size				
PSE-350X2.5	2½"	9/16"	7/8"	Call for Pricing
PSE-350X4	4"	9/16"	1"	
PSE-350X5.5	5½"	9/16"	1"	
PSE-350X7	7"	9/16"	1"	
1/8" Pipe Size				
PSE-351X2.5	2½"	9/16"	7/8"	Call for Pricing
PSE-351X4	4"	9/16"	1"	
PSE-351X5.5	5½"	9/16"	1"	
PSE-351X7	7"	9/16"	1"	
PSE-351X8.5	8½"	9/16"	1"	
PSE-351X10	10"	9/16"	1"	
PSE-351X11.5	11½"	9/16"	1"	
PSE-351X13	13"	9/16"	1"	
1/4" Pipe Size				
PSE-352X2.5	2½"	9/16"	7/8"	Call for Pricing
PSE-352X4	4"	9/16"	1¼"	
PSE-352X5.5	5½"	9/16"	1¼"	
PSE-352X7	7"	9/16"	1¼"	
PSE-352X8.5	8½"	9/16"	1¼"	
PSE-352X10	10"	9/16"	1¼"	
PSE-352X11.5	11½"	9/16"	1¼"	
PSE-352X13	13"	9/16"	1¼"	
3/8" Pipe Size				
PSE-353X2.5	2½"	11/16"	1"	Call for Pricing
PSE-353X4	4"	11/16"	1¼"	
PSE-353X5.5	5½"	11/16"	1¼"	
PSE-353X7	7"	11/16"	1¼"	
PSE-353X8.5	8½"	11/16"	1¼"	
PSE-353X10	10"	11/16"	1¼"	
PSE-353X11.5	11½"	11/16"	1¼"	
PSE-353X13	13"	11/16"	1¼"	
1/2" Pipe Size				
PSE-354X2.5	2½"	7/8"	1½"	Call for Pricing
PSE-354X4	4"	7/8"	1½"	
PSE-354X5.5	5½"	7/8"	1½"	
PSE-354X7	7"	7/8"	1½"	
PSE-354X8.5	8½"	7/8"	1½"	
PSE-354X10	10"	7/8"	1½"	
PSE-354X11.5	11½"	7/8"	1½"	
PSE-354X13	13"	7/8"	1½"	

500 Series

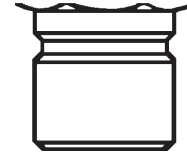

1/2" Hole (Actual Size)

PART NO.	"L"	HEX SIZE	"A"	PRICE EACH
1/16" Pipe Size				
Available on request.				
1/8" Pipe Size				
Available on request.				
1/4" Pipe Size				
Available on request.				
3/8" Pipe Size				
PSE-553X2.5	2½"	13/16"	1½"	Call for Pricing
PSE-553X4	4"	13/16"	1¾"	
PSE-553X5.5	5½"	13/16"	1¾"	
PSE-553X7	7"	13/16"	1¾"	
PSE-553X8.5	8½"	13/16"	1¾"	
PSE-553X10	10"	13/16"	1¾"	
PSE-553X11.5	11½"	13/16"	1¾"	
PSE-553X13	13"	13/16"	1¾"	
1/2" Pipe Size				
PSE-554X2.5	2½"	7/8"	1½"	Call for Pricing
PSE-554X4	4"	7/8"	1½"	
PSE-554X5.5	5½"	7/8"	1½"	
PSE-554X7	7"	7/8"	1½"	
PSE-554X8.5	8½"	7/8"	1½"	
PSE-554X10	10"	7/8"	1½"	
PSE-554X11.5	11½"	7/8"	1½"	
PSE-554X13	13"	7/8"	1½"	

Brass Combination Hose Inserts

FEATURES:

- Eliminates Multiple Fittings and Assembly — Put A Combination Hose Insert on One End of a Hose and a Coupler on The Other — Hoses May Then Be Snapped Together in Series
- All Flow Diameters Maximized to Reduce Restrictions
- For Use with Push-Lock or Standard Hose

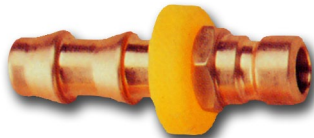
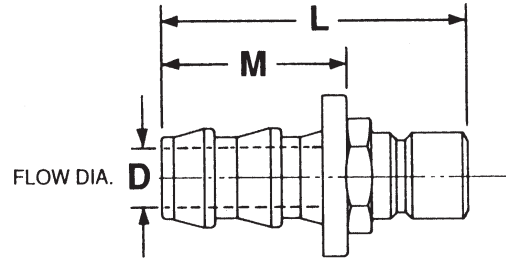

**200
SERIES**

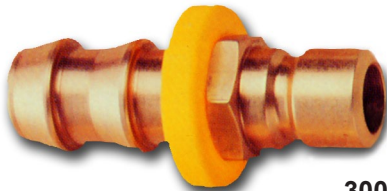

**300
SERIES**

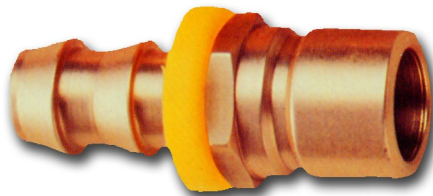

**500
SERIES**

SERIES	PART NO.	HOSE I.D.	"D"	"M"	"L"	PRICE EACH
SERIES 200 1/4" Hole	200-4	1/4"	3/16"	7/8"	1 ³ / ₈ "	Call for Pricing
	200-5	5/16"	1/4"	7/8"	1 ³ / ₈ "	
	200-6	3/8"	1/4"	1 ¹ / ₁₆ "	1 ⁹ / ₁₆ "	
	200-8	1/2"	1/4"	1 ¹ / ₁₆ "	1 ⁹ / ₁₆ "	
SERIES 300 3/8" Hole	300-4	1/4"	3/16"	7/8"	1 ¹³ / ₁₆ "	
	300-5	5/16"	1/4"	7/8"	1 ¹³ / ₁₆ "	
	300-6	3/8"	9/32"	1 ¹ / ₁₆ "	1 ¹³ / ₁₆ "	
	300-8	1/2"	11/32"	1 ¹ / ₁₆ "	1 ¹³ / ₁₆ "	
SERIES 500 1/2" Hole	500-8	1/2"	13/32"	1 ¹ / ₁₆ "	2"	
	500-12	3/4"	9/16"	1 ¹ / ₂ "	2 ¹ / ₂ "	

Brass Cover Plugs

FEATURES:

- Stops Coolant Flow on Hoses With Flow-thru Couplers
- Prevents Accidents by Plugging Unused Hoses and Manifold Ports
- Keeps Couplers and Seals Clean When Not in Use

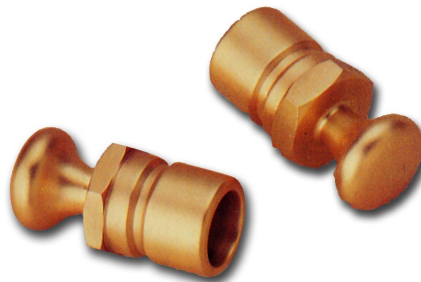

PART NO.	FITS SOCKET SERIES NO.	PRICE EACH
CP-200	200 (1/4" Hole)	Call for Pricing
CP-300	300 (3/8" Hole)	
CP-500	500 (1/2" Hole)	

Brass Hex Extension Elbows

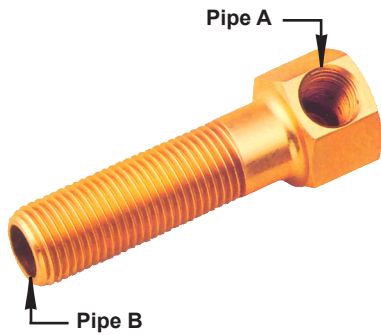

FEATURES:

- Positive Socket Wrench Installation
- 1-piece Construction Ensures Positive Alignment and Complete Removal
- Easy Length Adjustment with Adjustable Threads
- Custom Elbows are Available in Exact Lengths and a Wide Variety of Thread Combinations

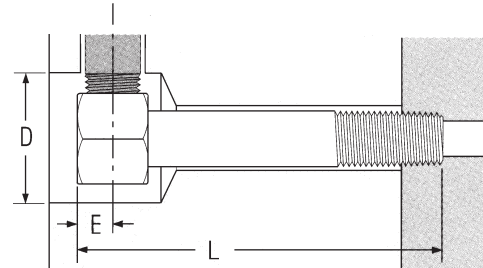

PART NO.	PIPE SIZE "A" (NPT)	PIPE SIZE "B" (NPT)	HEX SIZE	WRENCH CLEARANCE DIA. "D"	"E"	OVERALL LENGTH "L"							
						2 1/2"	4"	5 1/2"	7"	8 1/2"	10"	11 1/2"	13"
18B-*	1/8	1/8	3/4"	1 1/4"	9/32"	Call for Pricing 800-627-1033							
1814B-*	1/8	1/4	3/4"	1 1/4"	9/32"								
14B-*	1/4	1/4	7/8"	1 3/8"	11/32"								
1438B-*	1/4	3/8	7/8"	1 3/8"	11/32"								
38B-*	3/8	3/8	1"	1 1/2"	1/2"								
50B-*	1/2	1/2	1 1/4"	1 3/4"	5/8"								

*To order, insert desired overall length; Example: 14B-212

Hex Elbows

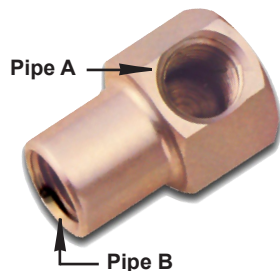

FEATURES:

- Available in Brass or Zinc-plated Steel
- Easy Socket Wrench Installation and Removal
- Angular Flow Path Allows Connecting Fittings to be Torqued Tight Without Choking Off Flow
- Requires Much Smaller Clearance Diameter Than Standard Pipe Elbows

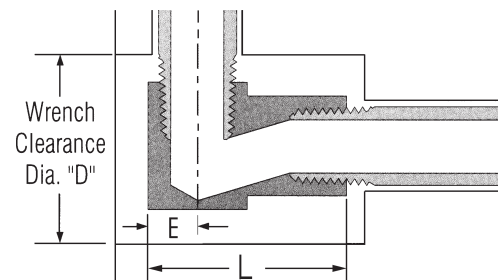

PIPE SIZE "A" (NPT)	PIPE SIZE "B" (NPT)	"L"	"E"	WRENCH CLEARANCE DIA. "D"	HEX SIZE	STEEL		BRASS	
						PART NO.	PRICE EACH	PART NO.	PRICE EACH
1/16	1/16	13/16"	7/32"	1"	9/16"	16S	Call for Pricing	16B	Call for Pricing
1/8	1/8	1"	9/32"	1 1/4"	3/4"	18S		18B	
1/8	1/4	1 1/4"	9/32"	1 1/4"	3/4"	1814S		1814B	
1/4	1/4	1 3/8"	11/32"	1 3/8"	7/8"	14S		14B	
1/4	3/8	1 3/8"	11/32"	1 3/8"	7/8"	1438S		1438B	
3/8	3/8	1 5/8"	1/2"	1 1/2"	1"	38S		38B	
1/2	1/2	1 7/8"	9/16"	1 7/8"	1 1/4"	50S		50B	
3/4	3/4	2 1/4"	5/8"	2 1/4"	1 1/2"	75S		75B	

Brass Hexkey Street Elbows

FEATURES:

- Extra Heavy Duty Hex Socket Allows Maximum Assembly Torque
- Hexkey Street Elbows Install With an Allen Wrench for Positive Assembly and Removal
- Angular Flow Path Allows Connecting Fittings to be Torqued Tight Without Choking Off Flow

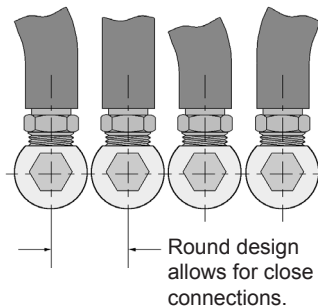
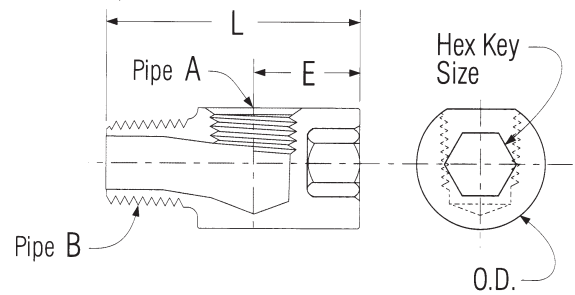

PART NO.	PIPE SIZE "A" (NPT)	PIPE SIZE "B" (NPT)	"L"	"E"	O.D.	MIN. CLEARANCE DIA.	HEX KEY SIZE	PRICE EACH
KL16	1/16	1/16	1.156"	.531"	.552"	9/16"	1/4"	Call for Pricing
KL1618	1/16	1/8	1.218"	.531"	.615"	5/8"	5/16"	
KL18	1/8	1/8	1.312"	.580"	.615"	5/8"	5/16"	
KL1814	1/8	1/4	1.500"	.593"	.860"	7/8"	3/8"	
KL14	1/4	1/4	1.625"	.660"	.860"	7/8"	3/8"	
KL1438	1/4	3/8	1.625"	.712"	.985"	1"	1/2"	
KL38	3/8	3/8	1.750"	.780"	.985"	1"	1/2"	
KL50	1/2	1/2	2.250"	.940"	1.235"	1 1/4"	1/2"	

Brass Hexkey Elbows

FEATURES:

- Hexkey Elbows Install With an Allen Wrench for Positive Assembly and Removal
- Compact, Round Design Allows for Close Connections
- Angular Coolant Path Prevents Fitting Interference at Assembly and Guarantees Full Flow

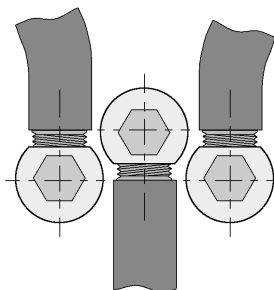
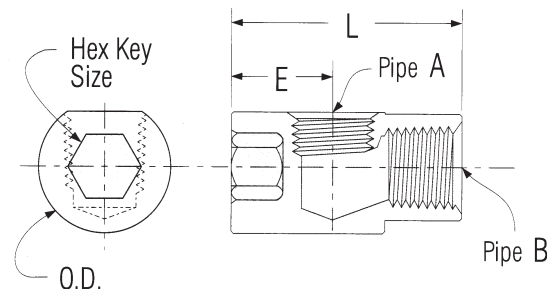
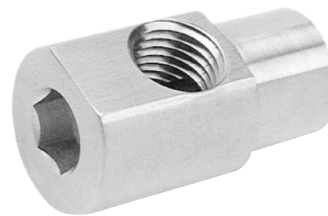

PART NO.	PIPE SIZE "A" (NPT)	PIPE SIZE "B" (NPT)	"L"	"E"	O.D.	MIN. CLEARANCE DIA.	HEX KEY SIZE	PRICE EACH
HKL16	1/16	1/16	1.125"	.531"	.552"	9/16"	1/4"	Call for Pricing
HKL18	1/8	1/8	1.250"	.580"	.615"	5/8"	5/16"	
HKL1814	1/8	1/4	1.375"	.593"	.860"	7/8"	3/8"	
HKL14	1/4	1/4	1.500"	.660"	.860"	7/8"	3/8"	
HKL1438	1/4	3/8	1.625"	.712"	.985"	1"	1/2"	
HKL38	3/8	3/8	1.750"	.780"	.985"	1"	1/2"	
HKL50	1/2	1/2	2.125"	.940"	1.235"	1 1/4"	1/2"	

Brass Hexkey Extension Elbows

FEATURES:

- Round Design Allows for Close Connections
- Extra Heavy Duty Hex Socket and 1-piece Construction Ensure Positive Assembly and Removal
- Hexkey Extension Elbows are Round and Install With an Allen Wrench — Wrench Clearance is Not Required, Making These Elbows Ideal for Use Inside the Mold or Anywhere Space is Limited
- Angular Flow Path Allows Connecting Pipe Fittings to be Torqued Tight Without Choking Off Flow
- Accurate Length Adjustments are Easy With the Patented Thread System
- Specifically Designed to Maintain High Flow Rates and Improve Cycle Times

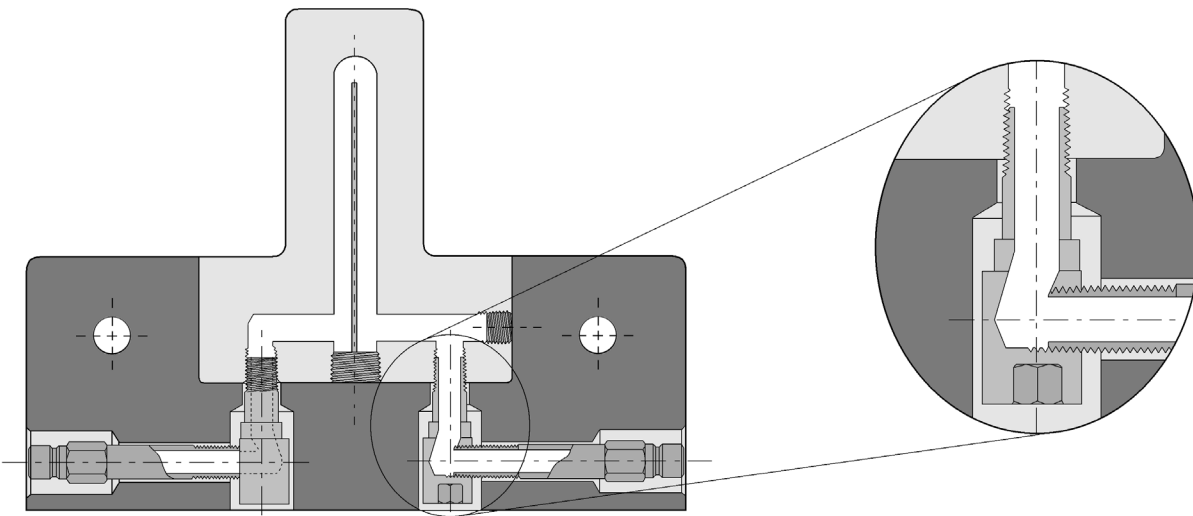
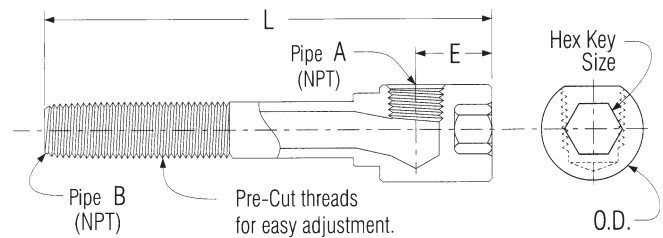

PART NO.	PIPE SIZE "A" (NPT)	PIPE SIZE "B" (NPT)	"E"	O.D.	MIN. CLEARANCE DIA.	HEX KEY SIZE	OVERALL LENGTH "L"						
							2½"	4"	5½"	7"	8½"	10"	11½"
EKL16-*	1/16	1/16	.531"	.552"	9/16"	1/4"	Call for Pricing 800-627-1033						
EKL18-*	1/8	1/8	.580"	.615"	5/8"	5/16"							
EKL14-*	1/4	1/4	.660"	.860"	7/8"	3/8"							
EKL38-*	3/8	3/8	.780"	.985"	1"	1/2"							
EKL50-*	1/2	1/2	.940"	1.235"	1¼"	1/2"							

*To order, insert desired overall length; Example: EKL14-212

Brass Hexkey Extension Pipes

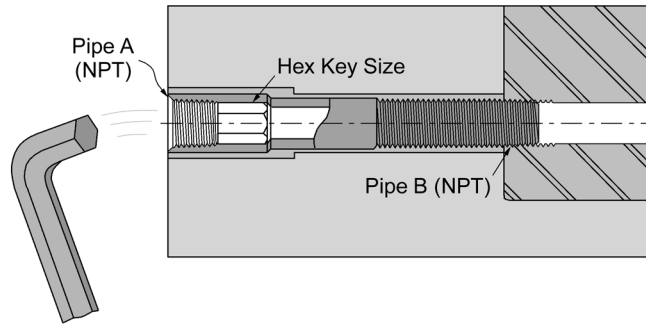
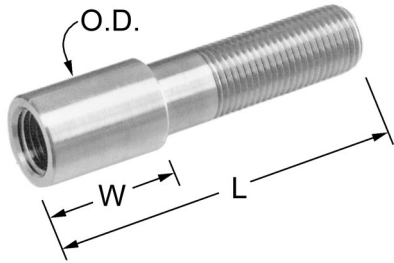

FEATURES:

- Heavy Duty Internal Hex Socket
- Hexkey Extension Pipes are Available in a Wide Variety of Special Lengths and Threads
- Accurate Length Adjustments are Easy With the Adjustable Thread System

PART NO.	PIPE SIZE "A" (NPT)	PIPE SIZE "B" (NPT)	"W"	O.D.	HEX KEY SIZE	OVERALL LENGTH "L"				
						2 1/2"	4"	5 1/2"	7"	8 1/2"
EP18-__*	1/8	1/8	3/4"	1/2"	1/4"	Call for Pricing 800-627-1033				
EP14-__*	1/4	1/4	1"	11/16"	3/8"					
EP38-__*	3/8	3/8	1 1/4"	13/16"	1/2"					
EP50-__*	1/2	1/2	1 1/2"	1"	9/16"					

*To order, insert desired overall length; Example: EP14-212

Piston Tubes

FEATURES:

- *Stainless Steel Tubes*
- Precision Brazed Assembly Provides High Strength and Reliable Performance
- Coolant Flows Through Hex Socket and High Flow Stainless Tube
- High-Flow Stainless Tube Provides Maximum Cooling Rates

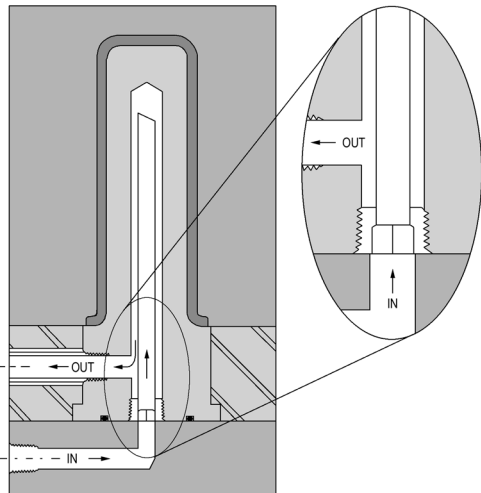
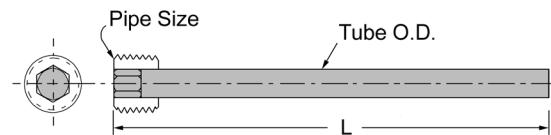
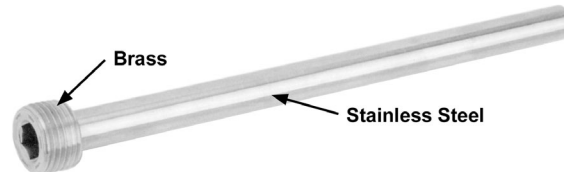

PART NO.	PIPE SIZE (NPT)	TUBE O.D.	TUBE I.D.	OVERALL LENGTH "L"			
				12"	24"	36"	48"
PT16-__B*	1/16	.125"	.109"	Call for Pricing 800-627-1033			
PT18-__B*	1/8	.187"	.167"				
PT14-__B*	1/4	.250"	.230"				
PT38-__B*	3/8	.375"	.345"				
PT12-__B*	1/2	.375"	.345"				
PT34-__B*	3/4	.437"	.407"				

*To order, insert desired overall length; Example: PT14-24B
Pipe plug also available in steel or stainless steel.

Brass Adjustable Hex Nipples

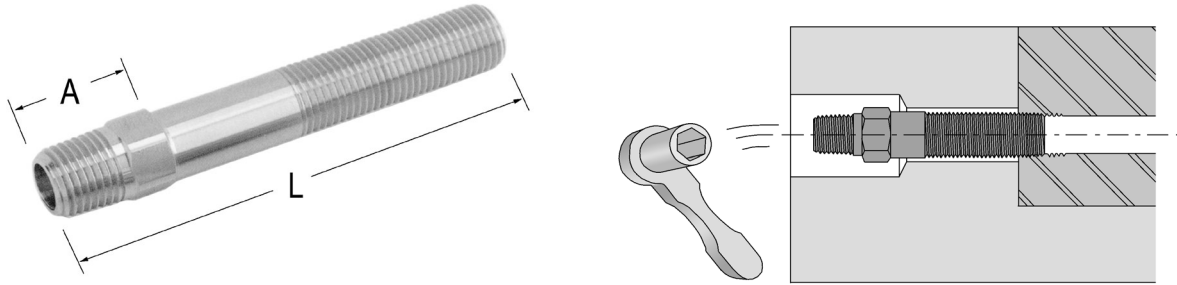

FEATURES:

- Adjustable Threads for Perfect Positioning
- Standard NPT Tapered Pipe Threads Both Ends
- Especially Useful When Installing Cascade Heads, Hex Elbows, etc. Inside Molds and Slides
- Longer or Special Exact Lengths Available
- Also Available in Special Thread Combinations

PART NO.	PIPE SIZE (NPT)	"A"	HEX SIZE	OVERALL LENGTH "L"							
				2½"	4"	5½"	7"	8½"	10"	11½"	13"
APN16-__*	1/16	11/16"	3/8	\$2.80	\$3.30	Call for Pricing 800-627-1033					
APN18-__*	1/8	3/4"	7/16	\$1.95	\$2.40						
APN14-__*	1/4	7/8"	9/16	\$2.15	\$2.60						
APN38-__*	3/8	1"	11/16	\$3.15	\$3.55						
APN12-__*	1/2	1⅜"	7/8	\$4.20	\$4.85						

*To order, insert desired overall length; Example: APN14- 212

Cam & Groove Couplers

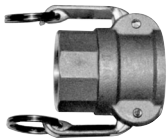

Available in 4 Different Materials For Use On All Types Of Hose

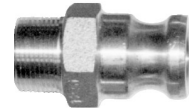

Aluminum

MATERIAL COMPONENTS:

- Buna-N Gaskets
- Aluminum Alloy — Specially Designed for High Tensile Strength, Lightness & Rigidity
- Brass Handles
- 315 Stainless Steel Pins
- Rings made from Spring Steel and Cadmium Plated

QUALITY CONTROL:

- Exacting Quality Control in Every Phase of Manufacturing Enables Compliance with Mil. Spec. 27487
- Interchangeable with Similar Types of Couplings That Are Manufactured to the Same Standards

WORKING PRESSURES:

- Tightness Under Pressure and Vacuum
- Tested at 300 psi up to 4" Size; 200 psi for 6" Size

Brass

MATERIAL COMPONENTS:

- Buna-N Gaskets
- Brass — Specially Designed for High Tensile Strength & Rigidity
- Brass Handles for Superior Strength
- Stainless Steel Pins
- Rings made from Spring Steel and Cadmium Plated

QUALITY CONTROL:

- Exacting Quality Control in Every Phase of Manufacturing Enables Compliance with Mil. Spec. 27487
- Interchangeable with Similar Types of Couplings That Are Manufactured to the Same Standards

WORKING PRESSURES:

- Tested at 150 psi up to 4" Size; 75 psi for 6" Size

Stainless Steel

MATERIAL COMPONENTS:

- Buna-N Gaskets
- Produced in Stainless Steel 316 (ASTM A351 Grade CF8M)
- Every Melt in the Foundry is Analyzed for Chemical Composition — A Chemical Test Certificate Showing the General Composition is Available Upon Request
- 304 Stainless Steel Pins
- Sintered Stainless Handles for Superior Strength
- Rings made from Spring Steel and Cadmium Plated

SAFETY FEATURE LOCKING HANDLES

QUALITY CONTROL:

- Exacting Quality Control in Every Phase of Manufacturing Enables Compliance with Mil. Spec. 27487
- Interchangeable with Similar Types of Couplings That Are Manufactured to the Same Standards

WORKING PRESSURES:

- Tested at 150 psi up to 4" Size

Sizes 1¼", 1½", 2", 2½", and 3" coupler parts B, C, D, and DC are supplied with a locking feature. Safety pins may be inserted to make locking handles to prevent disconnection during product transfer.

**Also available in 304 Stainless Steel

Replacement Gaskets

- Available in Buna-N (furnished as standard on parts B, C, and DC)

Buna-N Material Good for Oil Resistance and General Purpose Usage



Note: Replacement handle assemblies available on request.

Glass-Reinforced Nylon

MATERIAL COMPONENTS:

- Buna-N Gaskets on Parts B, C, D & DC
- Stainless Handles for Superior Strength on Some Models

SAFETY FEATURE LOCKING HANDLES

WORKING PRESSURES:



- Tested at 175 psi for ½" to 1" Size; 150 psi for 1½" to 2" Size; 125 psi for 3" Size; and 75 psi for 4" Size
- Temperature Range: -30°F to +200°F

Coupler parts B, C, D, and DC are supplied with Stainless Steel handles. Use safety clips provided in handles to make locking handle.

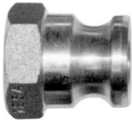
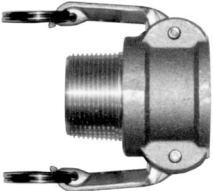
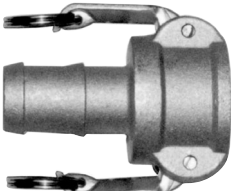
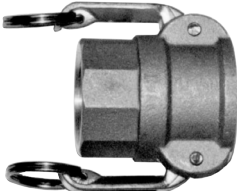

CALL FOR PRICING
800-627-1033

PART NO.	SIZE	PRICE EACH
BN-34	¾"	Call for Pricing 800-627-1033
BN-1	1"	
BN-114	1¼"	
BN-112	1½"	
BN-2	2"	
BN-212	2½"	
BN-3	3"	
BN-4	4"	
BN-5	5"	
BN-6	6"	

	NPT & HOSE SIZE	ALUMINUM		BRASS		STAINLESS STEEL -316	
		PART NO.	PRICE EACH	PART NO.	PRICE EACH	PART NO.	PRICE EACH
	PART A - Adapter X Female NPT						
	3/4"	AL-A34	Call for Pricing	BR-A34	Call for Pricing	SS-A34	Call for Pricing
	1"	AL-A1		BR-A1		SS-A1	
	1 1/4"	AL-A114		BR-A114		SS-A114	
	1 1/2"	AL-A112		BR-A112		SS-A112	
	2"	AL-A2		BR-A2		SS-A2	
	2 1/2"	AL-A212		BR-A212		SS-A212	
	3"	AL-A3		BR-A3		SS-A3	
	4"	AL-A4		BR-A4		SS-A4	
	5"	AL-A5		BR-A5		SS-A5	
	6"	AL-A6		BR-A6		SS-A6	
8"	AL-A8	N/A		N/A			
8"	AL-A8HD	N/A	N/A				
	PART B - Coupler X Male NPT						
	3/4"	AL-B34	Call for Pricing	BR-B34	Call for Pricing	SS-B34	Call for Pricing
	1"	AL-B1		BR-B1		SS-B1	
	1 1/4"	AL-B114		BR-B114		SS-B114	
	1 1/2"	AL-B112		BR-B112		SS-B112	
	2"	AL-B2		BR-B2		SS-B2	
	2 1/2"	AL-B212		BR-B212		SS-B212	
	3"	AL-B3		BR-B3		SS-B3	
	4"	AL-B4		BR-B4		SS-B4	
	5"	AL-B5		BR-B5		SS-B5	
	6"	AL-B6		BR-B6		SS-B6	
	PART C - Coupler X Hose Shank						
	3/4"	AL-C34	Call for Pricing	BR-C34	Call for Pricing	SS-C34	Call for Pricing
	1"	AL-C1		BR-C1		SS-C1	
	1 1/4"	AL-C114		BR-C114		SS-C114	
	1 1/2"	AL-C112		BR-C112		SS-C112	
	2"	AL-C2		BR-C2		SS-C2	
	2 1/2"	AL-C212		BR-C212		SS-C212	
	3"	AL-C3		BR-C3		SS-C3	
	4"	AL-C4		BR-C4		SS-C4	
	5"	AL-C5		BR-C5		SS-C5	
	6"	AL-C6		BR-C6		SS-C6	
8"	AL-C8	N/A		N/A			
8"	AL-C8HD	N/A	N/A				
	PART D - Coupler X Female NPT						
	3/4"	AL-D34	Call for Pricing	BR-D34	Call for Pricing	SS-D34	Call for Pricing
	1"	AL-D1		BR-D1		SS-D1	
	1 1/4"	AL-D114		BR-D114		SS-D114	
	1 1/2"	AL-D112		BR-D112		SS-D112	
	2"	AL-D2		BR-D2		SS-D2	
	2 1/2"	AL-D212		BR-D212		SS-D212	
	3"	AL-D3		BR-D3		SS-D3	
	4"	AL-D4		BR-D4		SS-D4	
	5"	AL-D5		BR-D5		SS-D5	
	6"	AL-D6		BR-D6		SS-D6	
8"	AL-D8	N/A		N/A			
	PART E - Adapter X Hose Shank						
	3/4"	AL-E34	Call for Pricing	BR-E34	Call for Pricing	SS-E34	Call for Pricing
	1"	AL-E1		BR-E1		SS-E1	
	1 1/4"	AL-E114		BR-E114		SS-E114	
	1 1/2"	AL-E112		BR-E112		SS-E112	
	2"	AL-E2		BR-E2		SS-E2	
	2 1/2"	AL-E212		BR-E212		SS-E212	
	3"	AL-E3		BR-E3		SS-E3	
	4"	AL-E4		BR-E4		SS-E4	
	5"	AL-E5		BR-E5		SS-E5	
	6"	AL-E6		BR-E6		SS-E6	
8"	AL-E8	N/A		N/A			
8"	AL-E8HD	N/A	N/A				

Glass-reinforced also available. Call for pricing.

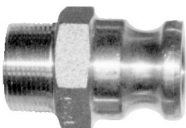
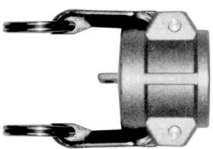
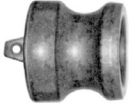

	NPT & HOSE SIZE	ALUMINUM		BRASS		STAINLESS STEEL -316	
		PART NO.	PRICE EACH	PART NO.	PRICE EACH	PART NO.	PRICE EACH
	PART F - Adapter X Male NPT						
	3/4"	AL-F34	Call for Pricing	BR-F34	Call for Pricing	SS-F34	Call for Pricing
	1"	AL-F1		BR-F1		SS-F1	
	1 1/4"	AL-F114		BR-F114		SS-F114	
	1 1/2"	AL-F112		BR-F112		SS-F112	
	2"	AL-F2		BR-F2		SS-F2	
	2 1/2"	AL-F212		BR-F212		SS-F212	
	3"	AL-F3		BR-F3		SS-F3	
	4"	AL-F4		BR-F4		SS-F4	
	5"	AL-F5		BR-F5		SS-F5	
6"	AL-F6	BR-F6		SS-F6			
	PART DC - Dust Cap						
	3/4"	AL-DC34	Call for Pricing	BR-DC34	Call for Pricing	SS-DC34	Call for Pricing
	1"	AL-DC1		BR-DC1		SS-DC1	
	1 1/4"	AL-DC114		BR-DC114		SS-DC114	
	1 1/2"	AL-DC112		BR-DC112		SS-DC112	
	2"	AL-DC2		BR-DC2		SS-DC2	
	2 1/2"	AL-DC212		BR-DC212		SS-DC212	
	3"	AL-DC3		BR-DC3		SS-DC3	
	4"	AL-DC4		BR-DC4		SS-DC4	
	5"	AL-DC5		BR-DC5		SS-DC5	
6"	AL-DC6	BR-DC6		SS-DC6			
	PART DP - Dust Plug						
	3/4"	AL-DP34	Call for Pricing	BR-DP34	Call for Pricing	SS-DP34	Call for Pricing
	1"	AL-DP1		BR-DP1		SS-DP1	
	1 1/4"	AL-DP114		BR-DP114		SS-DP114	
	1 1/2"	AL-DP112		BR-DP112		SS-DP112	
	2"	AL-DP2		BR-DP2		SS-DP2	
	2 1/2"	AL-DP212		BR-DP212		SS-DP212	
	3"	AL-DP3		BR-DP3		SS-DP3	
	4"	AL-DP4		BR-DP4		SS-DP4	
	5"	AL-DP5		BR-DP5		N/A	
6"	AL-DP6	BR-DP6		SS-DP6			

Glass-reinforced also available. Call for pricing.

Cast Aluminum Quick Couplers

Specially designed as a quick acting coupler to fit over .065 aluminum tubing for **dry pneumatic systems only**, creating a full flow system minimizing material build-up. The rubber gasket in the nut compresses around the aluminum tubing and forms a seal when it is firmly tightened. Our SH Series Tigerflex PVC suction hoses that are fitted with a part "C" or "E" can be attached to the pneumatic conveying system that is fitted with a part "BC" or "FC".

Compression Quick Couplers



PART NO.	SIZE	PRICE EACH
Type "BC" Fitting		
AL-BC112	1 1/2"	Call for Pricing
AL-BC2	2"	
AL-BC212	2 1/2"	
AL-BC3	3"	





PART NO.	SIZE	PRICE EACH
Type "FC" Fitting		
AL-FC112	1 1/2"	Call for Pricing
AL-FC2	2"	
AL-FC212	2 1/2"	
AL-FC3	3"	



Also available for use with Schedule 40 Pipe. Call for pricing.

Weld Couplings

Socket Weld to Schedule 40 Metal Pipe

PIPE SIZE	ALUMINUM		STAINLESS STEEL -316		
	PART NO.	PRICE EACH	PART NO.	PRICE EACH	
	PART A - Male Adapter				
	1½"	AL-ASW112	Call for Pricing	SS-ASW112	Call for Pricing
	2"	AL-ASW2		SS-ASW2	
	2½"	AL-ASW212		SS-ASW212	
	3"	AL-ASW3		SS-ASW3	
	4"	AL-ASW4		SS-ASW4	
	5"	AL-ASW5		SS-ASW5	
6"	AL-ASW6	SS-ASW6			
	PART D - Female Coupler				
	1½"	AL-DSW112	Call for Pricing	SS-DSW112	Call for Pricing
	2"	AL-DSW2		SS-DSW2	
	2½"	AL-DSW212		SS-DSW212	
	3"	AL-DSW3		SS-DSW3	
	4"	AL-DSW4		SS-DSW4	
	5"	AL-DSW5		SS-DSW5	
6"	AL-DSW6	SS-DSW6			

Butt Weld To Schedule 40 Metal Pipe and Socket Weld To Nominal OD Metal Tubing

PIPE SIZE	ALUMINUM		STAINLESS STEEL		
	PART NO.	PRICE EACH	PART NO.	PRICE EACH	
	PART F - Male Adapter				
	1½"	AL-FBW112	Call for Pricing	SS-FBW112	Call for Pricing
	2"	AL-FBW2		SS-FBW2	
	2½"	AL-FBW212		SS-FBW212	
	3"	AL-FBW3		SS-FBW3	
	4"	AL-FBW4		SS-FBW4	
	5"	AL-FBW5		SS-FBW5	
6"	AL-FBW6	SS-FBW6			
	PART B - Female Coupler				
	1½"	AL-BBW112	Call for Pricing	SS-BBW112	Call for Pricing
	2"	AL-BBW2		SS-BBW2	
	2½"	AL-BBW212		SS-BBW212	
	3"	AL-BBW3		SS-BBW3	
	4"	AL-BBW4		SS-BBW4	
	5"	AL-BBW5		SS-BBW5	
6"	AL-BBW6	SS-BBW6			