



Manifold Quotation Request

To request a quote, complete this form and save. Open an email and attach the saved form. Email to: Sales@ServicesForPlastics.com

Contact Information:

Company: _____

Account Number (If known): _____

Name: _____

Phone: _____

Job Title: _____

Email: _____

Address: _____

Type of Business: _____

City: _____ State: _____

Zip Code: _____ Country: _____

How you found us: _____

Quotation Information:

Total Number of Ports: _____

Total Number of Ports per Half: _____

Color Required: ☐ Red (RD) ☐ Blue (BL) ☐ Black (BK) ☐ Clear (NC)

Divided manifolds are typically: half red and half blue; but can be ordered in any color.

Sides with Port Holes:

☐ A ☐ D

☐ B ☐ E

☐ C

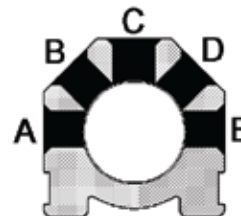

☐ Single Manifold

☐ Divided Manifold

Specify Input Size:

See diagrams for other dimensions.

☐ **M3**
3/4 NPT Input

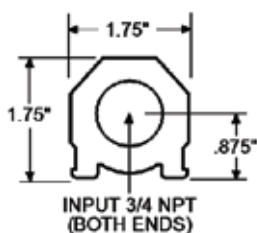

M3

☐ **M4**
1 NPT Input

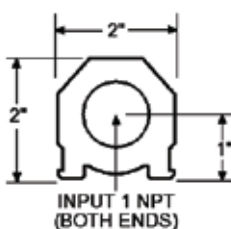

M4

☐ **M6**
1-1/2 NPT Input

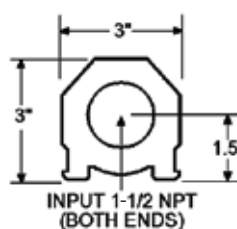

M6

☐ **M8**
2 NPT Input

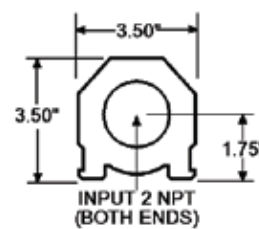

M8

Size of Port Holes:

☐ 1/8 NPT

☐ 1/4 NPT

☐ 1/4 NPT

☐ 3/8 NPT

☐ 1/4 NPT

☐ 3/8 NPT

☐ 1/2 NPT

☐ 3/4 NPT

☐ 1/2 NPT

☐ 3/4 NPT

☐ 1 NPT

Special Port Spacing for Ball Valves? ☐ Yes ☐ No

Standard port spacing is 1" for M3 manifolds; 1.25" for M4 manifolds; 2" for M6 manifolds; 2.25" for M8 manifolds.

NOTE: When using hot oil, specify a brass plug instead of the standard plug with o-ring.

NOTE: Custom Manifolds are non-returnable.

Other Information: